



# FACADE LIGHTING



## FACADE LIGHTING 2024

 C-Line-18 14	 C-Line-28 16	 C-Line-Sc 18	 Dot Diamond 20	 WL 22
 WLT 24	 WLTC 26	 WLP 28	 WS 30	 SUPREME 32
 SUPREME PRO 34	 WH 36	 WH ECO 38	 WH 5D 40	 LLFX 42
 CFU 44	 CFL 46	 CF1 48	 CF3 50	 CF5 52
 SNAKE 54	 IZ 56	 CIZ 58	 BELLA 60	 NODE2X 62
 NODE8X 64	 Industrial Pro 66			

# INTRODUCTION

---

Look around you! Above all, there was always light. It allows us to comprehend life, discerning between darkness and light, ignorance and wisdom. Light has played a crucial role in the advancement of humanity. Light has brought our eyes together with the colors of the world and bestowed upon us aesthetic feelings. If there is light, life is beautiful!

## *A better way to see!*

For over 30 years, we have been enhancing life with our illumination expertise. We realize turnkey lighting projects worldwide, to better appreciate the beauty life offers us. Our proficiency in design, engineering, and manufacturing seamlessly integrates technology and art. We offer tailored LED lighting solutions for various applications, including facade, park and garden, pool, outdoor and indoor spaces, industrial facilities, road, and decorative lighting areas.

SEE THE BUILDING  
THE CITY  
THE LIFE  
in *A BETTER WAY*



# STORY BEHIND THE POLAR BEAR

---

## *Harnessing Nature's Brilliance for Sustainable Lighting*

*In the vast icy landscapes where polar bears reign supreme, the seemingly endless stretches of white are not just a shield against the cold, but a testament to the ingenious workings of nature. It's a common misconception that the thick white fur of polar bears solely protects them from the harsh Arctic temperatures. Contrary to appearances, the bears' skin is closer to black in color. What appears to be a simple coat of fur is, in fact, a marvel of natural engineering.*

*Each white hair in the polar bear's fur possesses fiber-optic properties, acting as a conduit for sunlight. Instead of merely providing insulation, these hairs channel sunlight directly to the bear's black-pigmented skin, where it is converted into heat. This incredible mechanism allows polar bears to maximize the efficiency of the sun's energy, adapting seamlessly to their environment. In much the same way, Fiberli draws inspiration from this remarkable synergy of nature. Our logo, symbolized by the polar bear, encapsulates our commitment to energy efficiency and the perfect harmony of technology and the environment. The polar bear's ability to harness sunlight aligns with Fiberli's ethos of utilizing cutting-edge technology to create lighting solutions that not only illuminate spaces with brilliance but also do so in the most sustainable manner.*



# TIMELINE

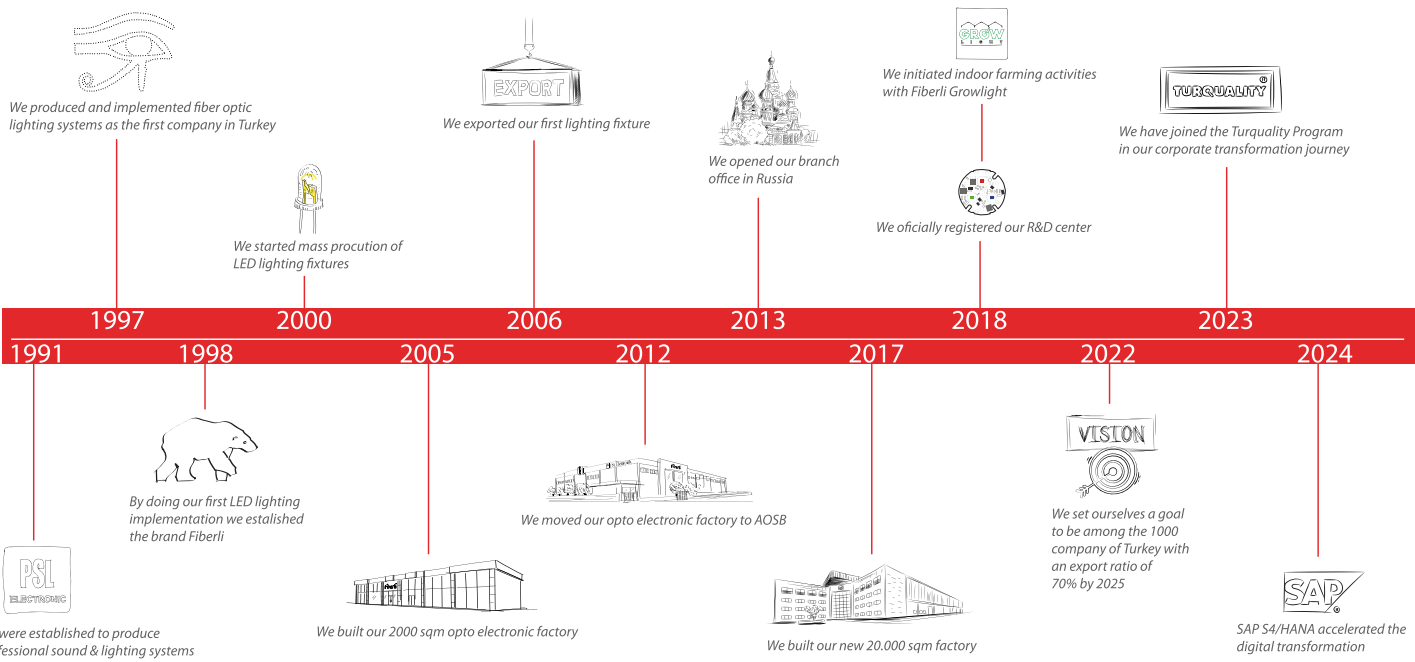

## TURNKEY PROJECTS WORLDWIDE



*since* **1991** *Export to* **70+** *countries* **23.000** *m<sup>2</sup>* **300+** *professionals*  
**factory**

Fiberli is accepted into TURQUALITY, trademark export program led by the Republic of Turkey

**IALDLIRC**

Fiberli is a member of The Lighting Industry Resource Council (LIRC)

## OUR VALUES

---

### VALUE TO LIFE

Our primary mission is to enhance the quality of our surroundings and enrich life through the transformative power of light. We approach all our projects with this guiding principle

### INNOVATION

In our pursuit to deepen our understanding of life, we are investing significantly in research and development, consistently pushing the boundaries of innovation through the adoption of new technologies

### SUSTAINABILITY

We advocate for energy efficiency through our environmentally friendly LED technology, ensuring conservation. Our operations are marked by an unwavering commitment to efficiency in all processes

### TRUSTWORTHINESS

We consider all our stakeholders as part of our own family and operate with a zero-problem policy, working with high responsibility

### INTEGRALITY

We provide our stakeholders with a comprehensive A-to-Z service, offering end-to-end solutions that encompass project planning, production, and installation. Delivering excellence from concept to execution, we strive to deliver high value in every aspect of our engagements

# TURNKEY PROJECTS WORLDWIDE









Financial District - İstanbul



Arena Kombëtare - Albania



DELTA

VIP

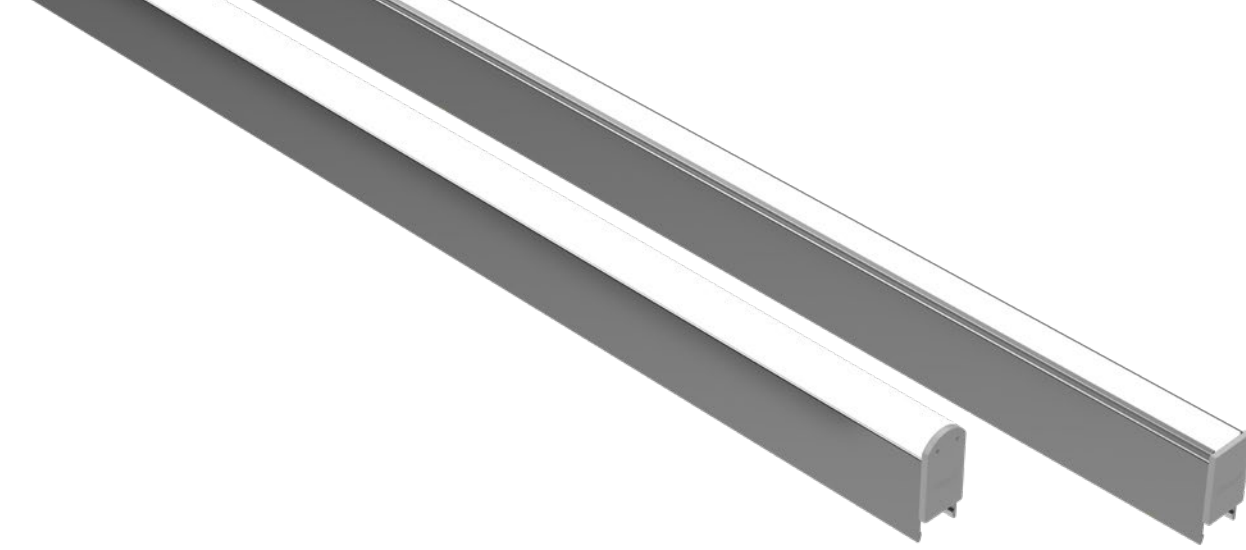

102 meters with single power entry

Clever LED Line

# C-LINE-18

With its outstanding slim design, Fiberli C-Line is produced with 30% less material compared to its previous versions, aligning with the sustainability goals of our contemporary world. The C-Line, crafted based on principles of circularity, sources all its raw materials from local suppliers, emphasizing a philosophy deeply rooted in sustainability and local circular economies without compromising on technology.

C-Line's Balanced High Voltage feature eliminates the need for electrical feedback cables in the field. This not only results in material savings but also accelerates project implementation by reducing assembly times. This innovative approach underscores the product's commitment to resource efficiency and timely project execution.

Finally, with its True Color technology, C-Line ensures the homogeneous and vibrant display of all colors by utilizing all energy specifically for each color while it is illuminated, rather than dividing the consumed energy across different colors. This innovative approach enhances the overall visual experience, emphasizing the product's commitment to vivid and consistent color representation.

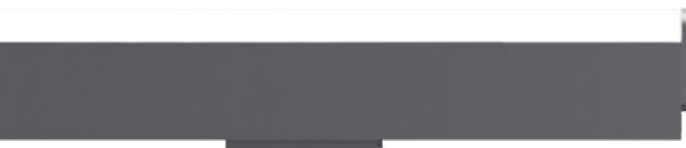

Balanced  
High Voltage



True  
Color



Lock &  
Light



Slim  
Design

## KEY FEATURES

- Balanced High Voltage Technology
- True Color
- Slim Design
- Lock & Light System
- High Efficiency Power (May varies based on the selection and current of the 2.4-19.2W LED)



Scan for more details

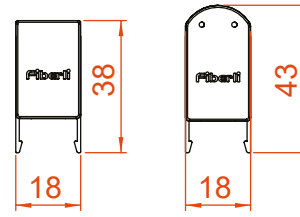

Product Overview

Light Color Options

- Red
  - Green
  - Blue
  - Amber
  - Warm White (3000K)
  - Natural White (4000K)
  - Cold White (6500K)
- 
- ● ● RGB
  - ● ● ● RGBW
  - ● ● ● ● RGBA

Mono Color (MC)

Multi Color

LED - Pixel - Power Options

- MC=15 cm/px = 0,67W/px
- MC=20 cm/px = 0,95W/px
- RGB=10 cm/px = 1,33W/px
- RGB=20 cm/px = 2,47W/px
- RGBW=10 cm/px = 1,71W/px
- RGBW=20 cm/px = 3,25W/px

Length

20/60/120 cm

Voltage

48V DC

Optical Options

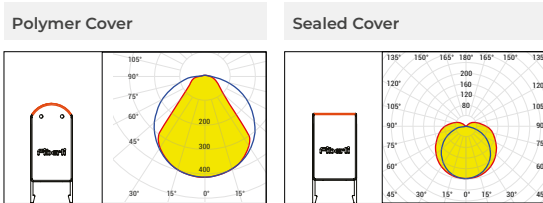

Mounting

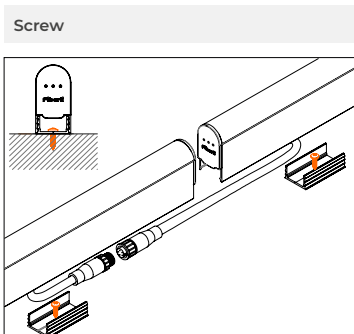

Body Color Options

- Anodized Grey
- RAL 7012
- RAL 9005

Cover Options

- Transparent
- Diffused
- Dark

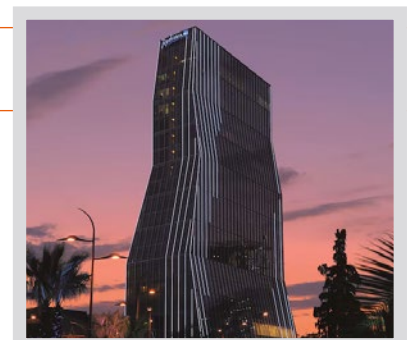

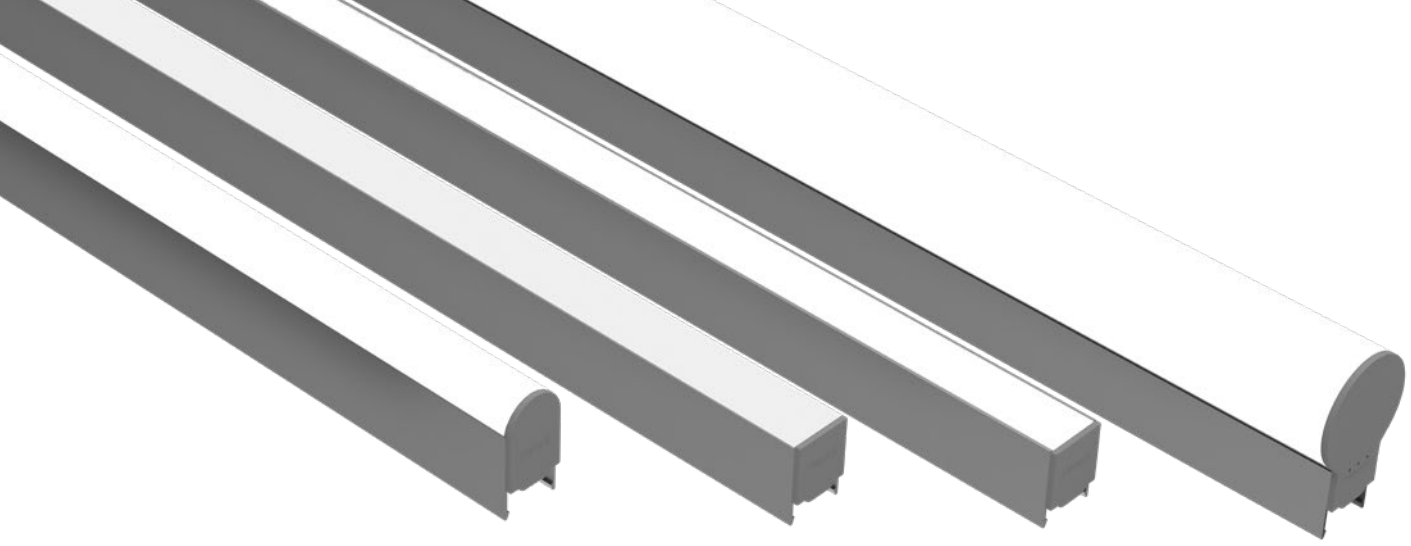

102 meters with single power entry

Clever LED Line

# C-LINE-28

With its outstanding slim design, Fiberli C-Line is produced with 30% less material compared to its previous versions, aligning with the sustainability goals of our contemporary world. The C-Line, crafted based on principles of circularity, sources all its raw materials from local suppliers, emphasizing a philosophy deeply rooted in sustainability and local circular economies without compromising on technology.

C-Line's Balanced High Voltage feature eliminates the need for electrical feedback cables in the field. This not only results in material savings but also accelerates project implementation by reducing assembly times. This innovative approach underscores the product's commitment to resource efficiency and timely project execution.

Finally, with its True Color technology, C-Line ensures the homogeneous and vibrant display of all colors by utilizing all energy specifically for each color while it is illuminated, rather than dividing the consumed energy across different colors. This innovative approach enhances the overall visual experience, emphasizing the product's commitment to vivid and consistent color representation.

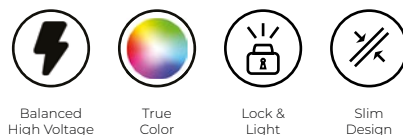
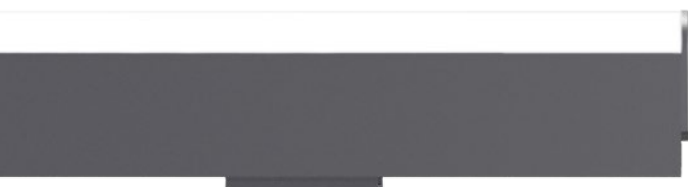

## KEY FEATURES

- Balanced High Voltage Technology
- True Color
- Slim Design
- Lock & Light System
- High Efficiency Power (May varies based on the selection and current of the 2.4-19.2W LED)



Scan for more details

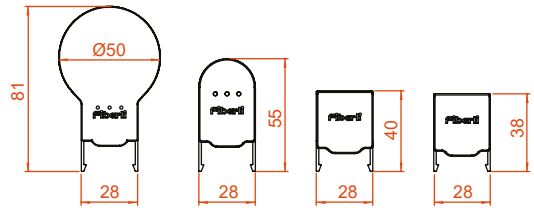
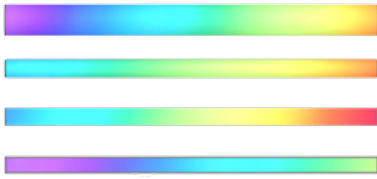

Product Overview

Light Color Options

	Red	Mono Color (MC)
	Green	
	Blue	
	Amber	
	Warm White (3000K)	
	Natural White (4000K)	
	Cold White (6500K)	
	RGB	Multi Color
	RGBW	
	RGBA	

LED - Pixel - Power Options

MC=15 cm/px = 0,67W/px
MC=20 cm/px = 0,95W/px
RGB=10 cm/px = 1,33W/px
RGB=20 cm/px = 2,47W/px
RGBW=10 cm/px = 1,71W/px
RGBW=20 cm/px = 3,25W/px

Length

20/60/120 cm

Voltage

48V DC

Optical Options

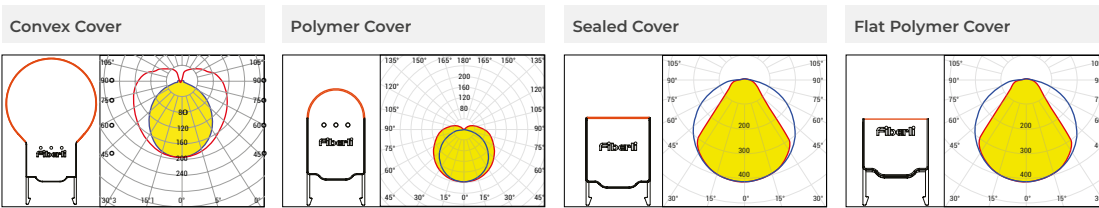

Mounting

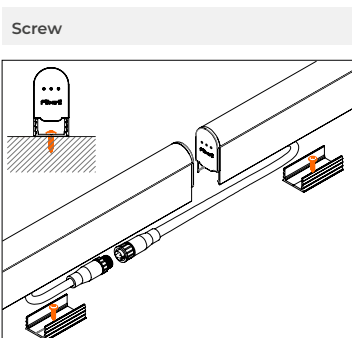

Body Color Options

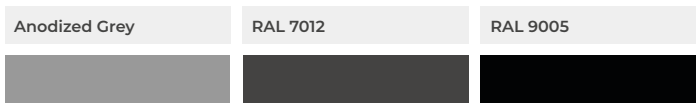

Cover Options

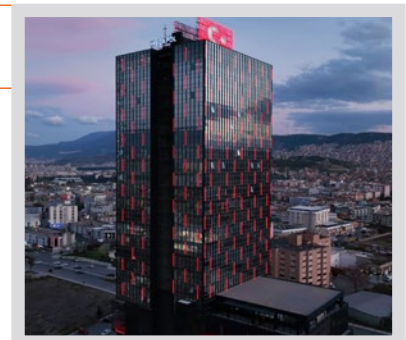
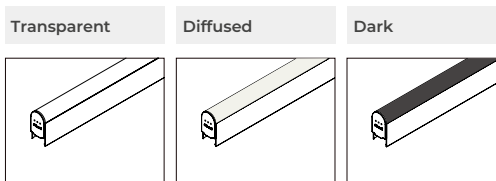





Relives the light

Clever LED Line

# C-LINE-Screen

With its outstanding slim design, Fiberli C-Line is produced with 30% less material compared to its previous versions, aligning with the sustainability goals of our contemporary world. The C-Line, crafted based on principles of circularity, sources all its raw materials from local suppliers, emphasizing a philosophy deeply rooted in sustainability and local circular economies without compromising on technology.

C-Line's Balanced High Voltage feature eliminates the need for electrical feedback cables in the field. This not only results in material savings but also accelerates project implementation by reducing assembly times. This innovative approach underscores the product's commitment to resource efficiency and timely project execution.

Finally, with its True Color technology, C-Line ensures the homogeneous and vibrant display of all colors by utilizing all energy specifically for each color while it is illuminated, rather than dividing the consumed energy across different colors. This innovative approach enhances the overall visual experience, emphasizing the product's commitment to vivid and consistent color representation.



Balanced  
High Voltage



True  
Color



Lock &  
Light



Slim  
Design

## KEY FEATURES

- Balanced High Voltage Technology
- True Color
- Slim Design
- Lock & Light System
- High Efficiency Power (May varies based on the selection and current of the 2.4-19.2W LED)

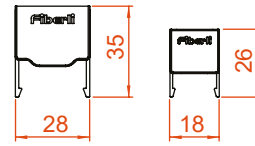

Product Overview

Light Color Options

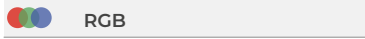

LED - Pixel - Power Options

RGB=6 cm/px = 0,84W/px  
 RGB=10 cm/px = 0,84W/px

Length

120 cm

Voltage

48V DC

Optical Options

SC18 Polymer Cover

SC28 Polymer Cover

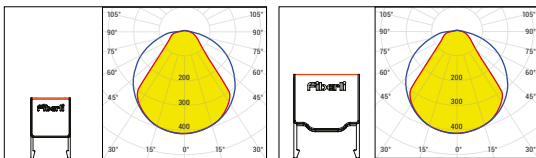

Mounting

Screw

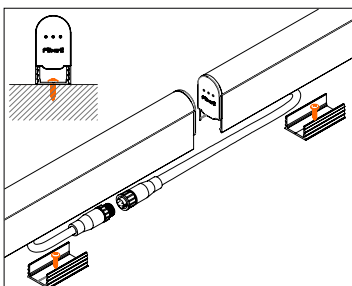

Body Color Options

Anodized Grey

RAL 7012

RAL 9005



SC28

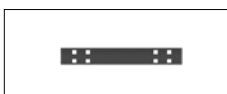

SC28

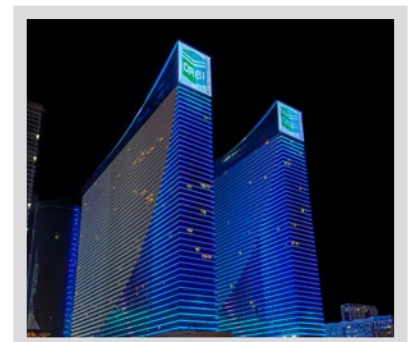
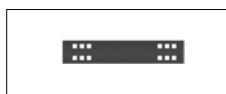

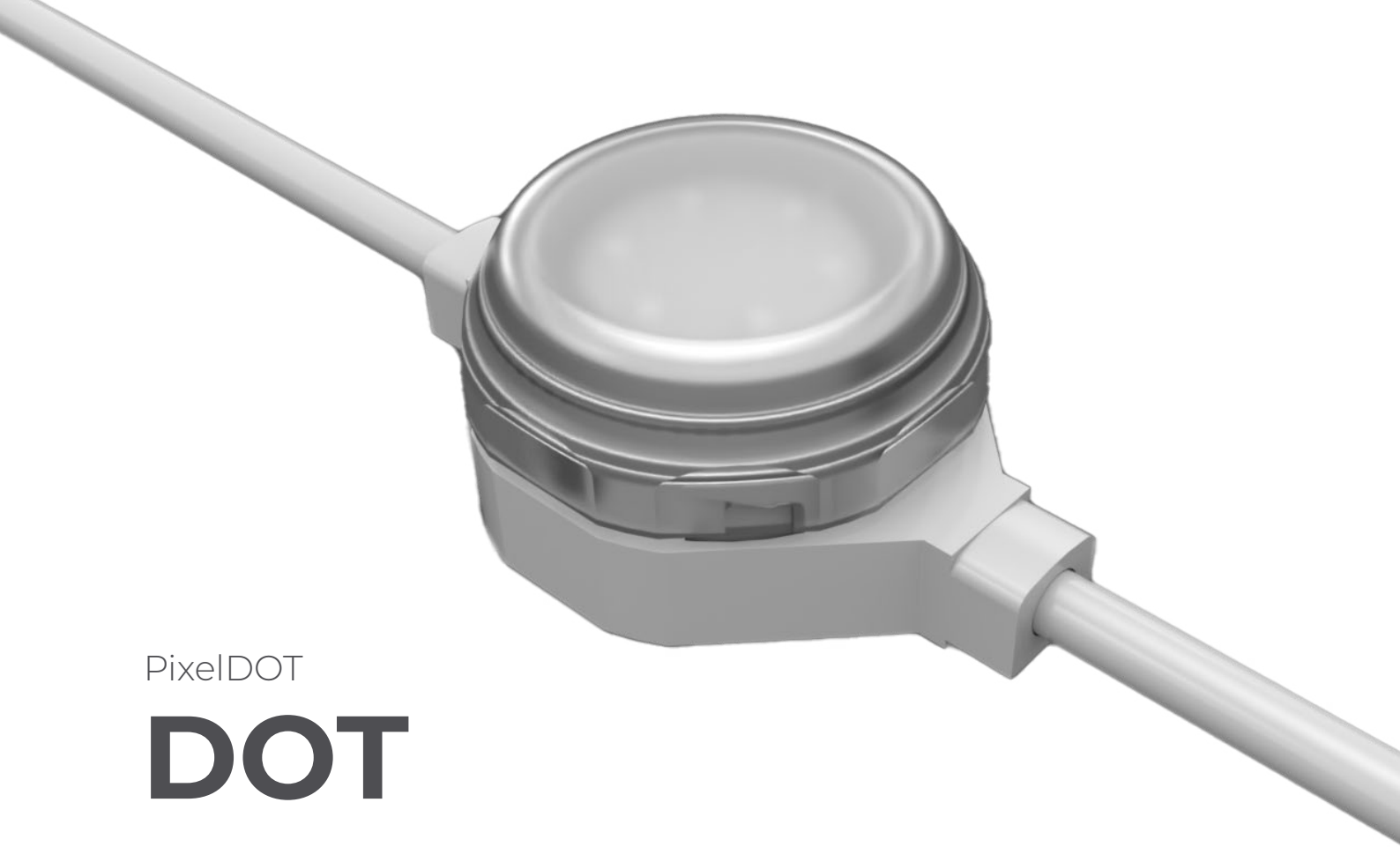

PixelDOT

# DOT DIAMOND

## Simple installation, removable dot

Crafted with ultralight materials, Dot Diamond eliminates concerns of additional static load on the facade, ensuring a harmonious blend of style and structural integrity. Our easy setup system (ESS) redefines efficiency by cutting down installation times to guarantee timely project implementation and smooth maintenance. What truly sets Dot Diamond apart is its individual control of each dot on the string, enabling sophisticated pixel mapping and, consequently, achieving advanced display quality.



Ultra  
Lightweight



Easy Setup  
System

### KEY FEATURES

---

- Individually controllable dots
- New gen chip RGBW
- Easy Setup System (ESS)
- Up to 50 dots per string
- Transparent or diffused cover options
- Ultra lightweight 70gr







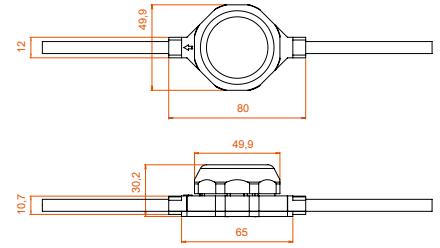





Scan for more details





Product Overview

Light Color Options

	Red	Mono Color (MC)
	Green	
	Blue	
	Amber	
	Warm White (3000K)	
	Natural White (4000K)	
	Cold White (6500K)	
	RGB	Multi-Color
	RGBW	
	RGBA	

LED - Pixel - Power Options

RGBW=20 cm/px = 2W/px	24/48V DC
RGBW=50 cm/px = 2W/px	
RGBW=60 cm/px = 2W/px	

Voltage

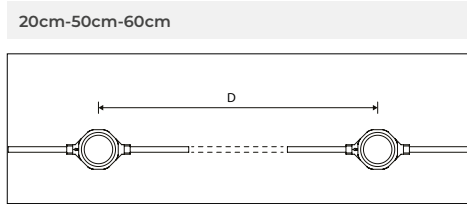
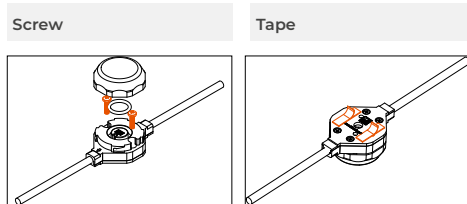

Mounting



Upper Cover Options



Body Color Options

RAL 9016	RAL 9005
	



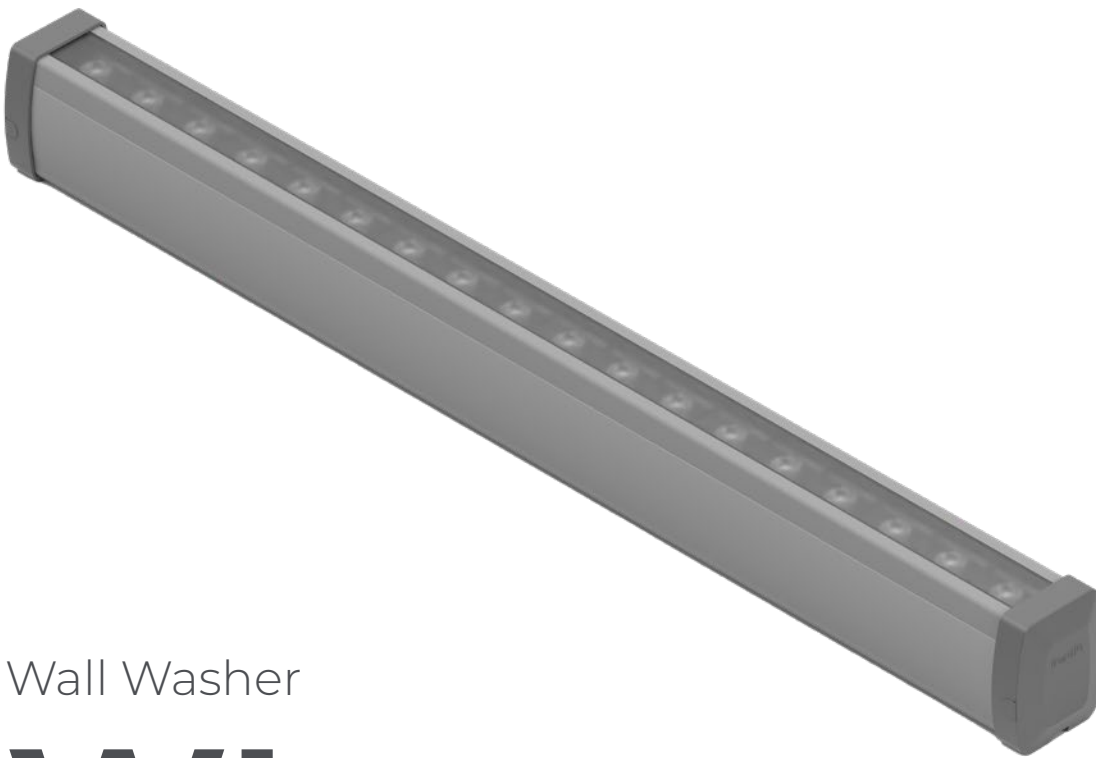

Wall Washer

# WL

## More than just a simple wall washer

WL is more than just a simple wall washer. With lighting capabilities ranging from 4 to 56 watt, it can transform into a powerful painting and lighting fixture with its dual, triple, and quadruple combinations. WL offers flexible solutions with its wired and socketed connection options, providing even and smooth illumination for the texture you want to highlight.



**WL-100mm**



**WL-200mm**



**WL-300mm**



**WL-600mm**



**WL-900mm**



**WL-1200mm**



Lightweight



Endless  
Connections

### KEY FEATURES

- Lightweight housing
- Endless connections



Scan for more details

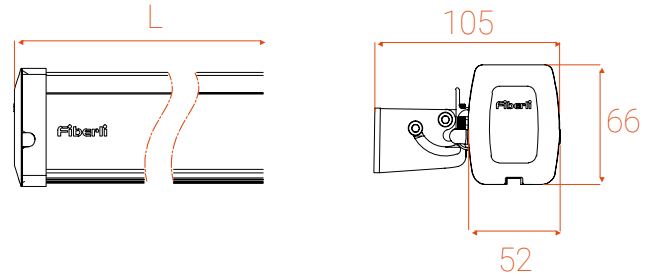
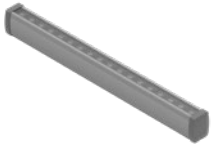

Product Overview

Light Color Options

	Red	Mono Color (MC)
	Green	
	Blue	
	Amber	
	Warm White (3000K)	
	Natural White (4000K)	
	Cold White (6500K)	Multi Color
	RGB	
	RGBW	
	RGBA	

Power	Voltage	Luminous Flux	Length(L)
4 W	220-240V AC	516 lm	100 mm
8 W		982 lm	200 mm
12 W		1.494 lm	300 mm
16 W		2.100 lm	300 mm
22 W		2.916 lm	600 mm
30 W		4.065 lm	600 mm
32 W		4.609 lm	900 mm
44 W		6.160 lm	900 mm
42 W		6.034 lm	1200 mm
58 W		8.013 lm	1200 mm

Lens Options

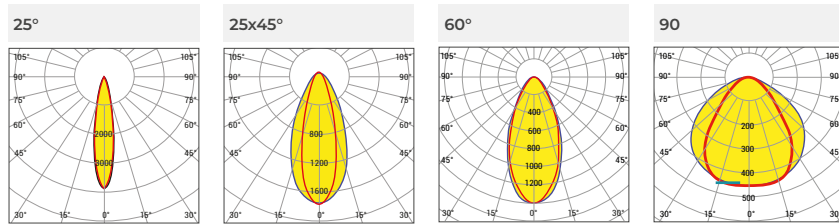

Mounting

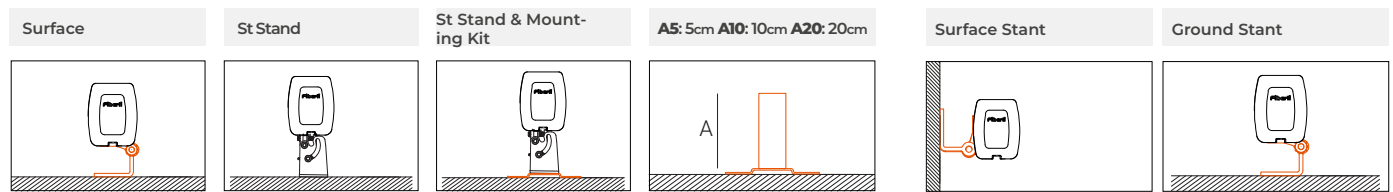

Upper Cover Options

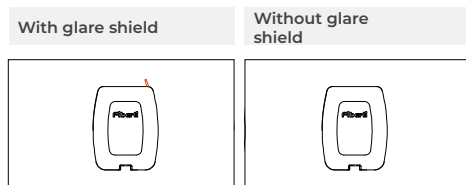

Body Color

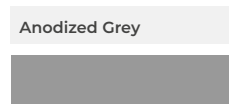

Cable Directions

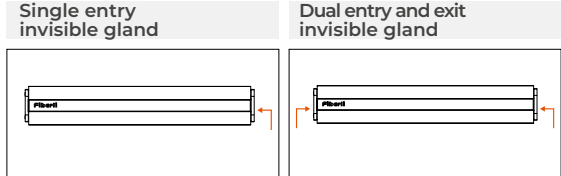

Additional Pieces Options

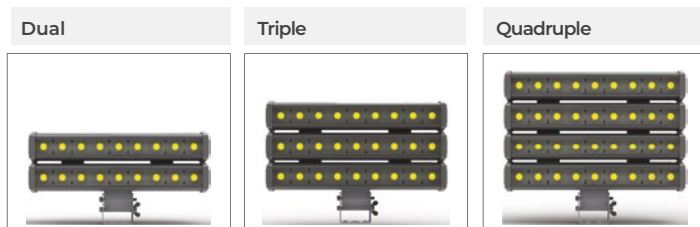

Connecting Fittings





Wall Washer

# WLT

Precise control, extended wall washing

Equipped with different lens options, WLT provides lighting designers, architects and consultants with precise beam control that would elevate architectural spaces to new heights, allowing for the creation of dynamic visual experiences tailored to perfection. WLT can graze up to 12 meters while homogeneously distributing the light along the pathway. With the active shield embedded in its structure, WLT wallwashers provide you with an experience of perfect balance between stunning illumination and gentle ambiance, eliminating glare and enhancing the overall aesthetic appeal of your environment based on visual comfort.

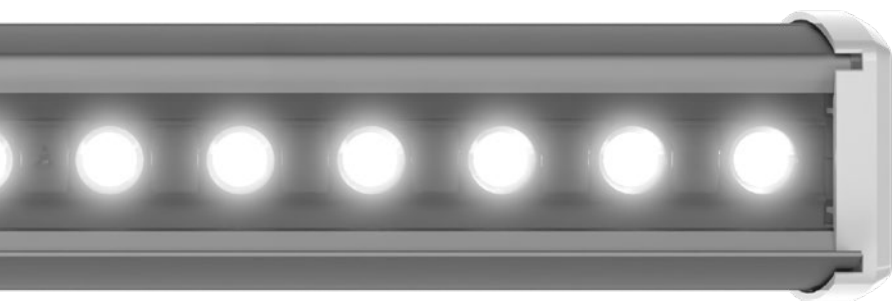

Active  
Shield

Anti Glare

High  
Graze

Precise  
Beam

## KEY FEATURES

- Active shield
- Extra durable tempered glass
- Wide choice of lenses
- Homogeneous graze effect up to 12 meters\*



Scan for more details

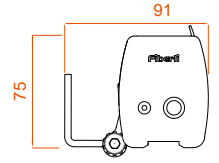
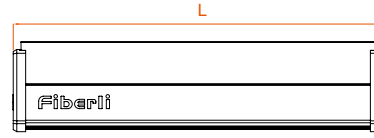

Product Overview

Light Color Options

<span style="color: red;">●</span> Red	Mono Color (MC)
<span style="color: green;">●</span> Green	
<span style="color: blue;">●</span> Blue	
<span style="color: orange;">●</span> Amber	
<span style="color: yellow;">●</span> Warm White (3000K)	
<span style="color: lightyellow;">●</span> Natural White (4000K)	
<span style="color: lightblue;">●</span> Cold White (6500K)	
<span style="color: red;">●</span> <span style="color: green;">●</span> <span style="color: blue;">●</span> RGB	Multi Color
<span style="color: red;">●</span> <span style="color: green;">●</span> <span style="color: blue;">●</span> <span style="color: yellow;">●</span> RGBW	
<span style="color: red;">●</span> <span style="color: green;">●</span> <span style="color: blue;">●</span> <span style="color: orange;">●</span> RGBA	

Power	Voltage	Luminous Flux	Length(L)
20 W	220-240V AC	2.424 lm	310 mm
35 W		4.335 lm	610 mm
50 W		6.322 lm	905 mm
65 W		8.023 lm	1215 mm
14 W		1.120 lm	310 mm
28 W		2.240 lm	610 mm
42 W		3.360 lm	905 mm
56 W		4.183 lm	1215 mm

Lens Options

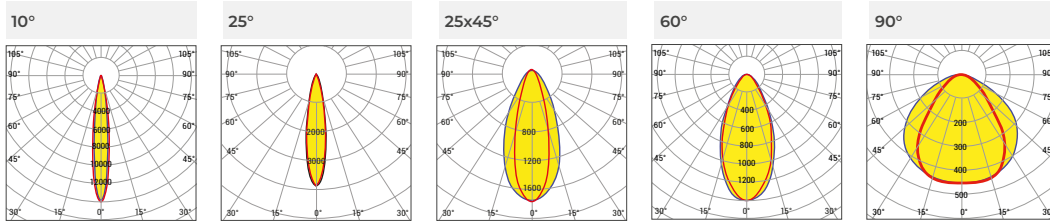

Mounting Options

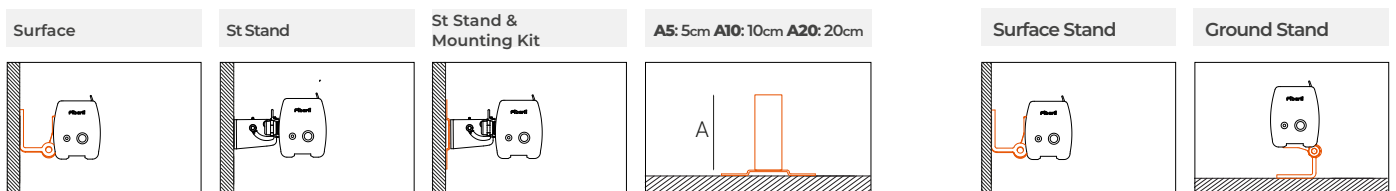

Upper Cover Options

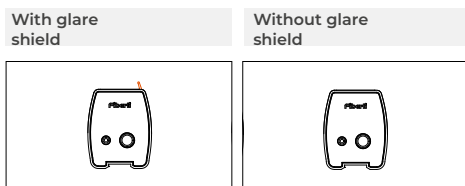

Body Color Options

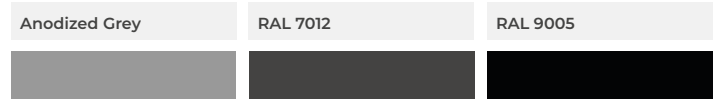

Cable Directions

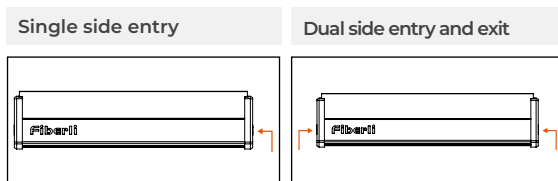

Additional Pieces Options

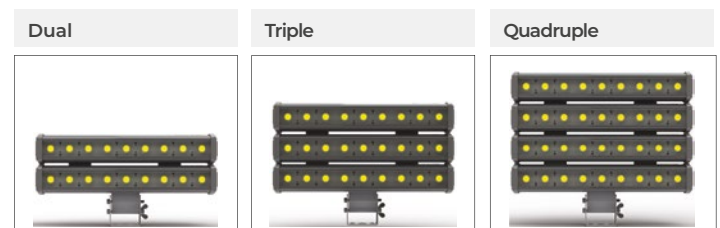



Dual Output  
Wall Washer

# WLTC

2 ways wall washer

Descended from WLT family, WLTC's bilateral output achieves an efficient and effective illumination of walls, pillars and architectural details. Its versatility allows for creative freedom in lighting design, ensuring that your facade not only looks exceptional but feels inviting and well-lit from every angle. The bilateral output of a wallwasher, emitting light both upward and downward, is a design strategy that maximizes the impact of lighting while using fewer fixtures. This approach offers several advantages, making it a highly efficient and effective choice for various applications.



Precise  
Beam



Anti Glare



Dual  
Output

## KEY FEATURES

- Extra durable tempered glass
- Wide choice of lenses
- Homogeneous graze effect up to 12 meters\*



Scan for more details

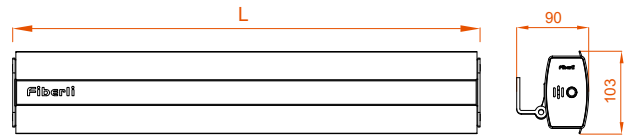
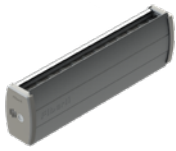

## Product Overview

### Light Color Options

<span style="color: red;">●</span> Red	Mono Color (MC)
<span style="color: green;">●</span> Green	
<span style="color: blue;">●</span> Blue	
<span style="color: orange;">●</span> Amber	
<span style="color: yellow;">●</span> Warm White (3000K)	
<span style="color: lightyellow;">●</span> Natural White (4000K)	
<span style="color: lightblue;">●</span> Cold White (6500K)	
<span style="color: red;">●</span> <span style="color: green;">●</span> <span style="color: blue;">●</span> RGB	Multi Color
<span style="color: red;">●</span> <span style="color: green;">●</span> <span style="color: blue;">●</span> <span style="color: orange;">●</span> RGBW	
<span style="color: red;">●</span> <span style="color: green;">●</span> <span style="color: blue;">●</span> <span style="color: orange;">●</span> RGBA	

Power	Voltage	Luminous Flux	Length(L)
8 W	220-240V AC	800 lm	110 mm
15 W		1.650 lm	183 mm
30 W		3.300 lm	330 mm
55 W		6.050 lm	625 mm
75 W		8.250 lm	920 mm
100 W		11.000 lm	1215 mm

### Lens Options

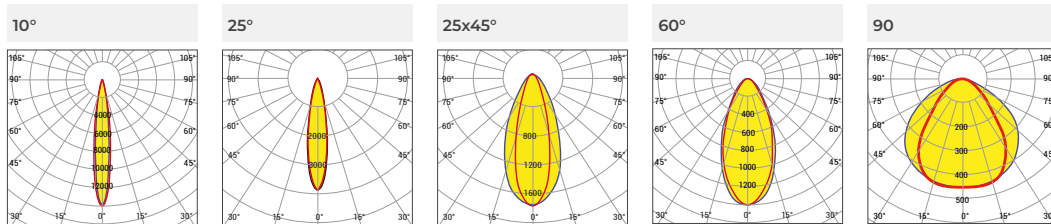

\*The upward and downward light outputs of WLTC can be different from each other with to various lens options

### Mounting

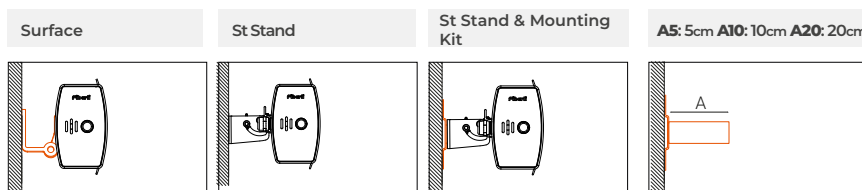

### Upper Cover Options

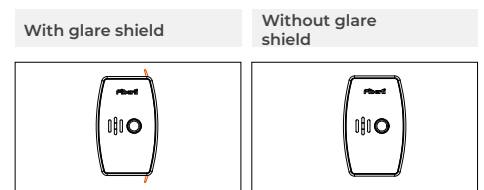

### Body Color Options

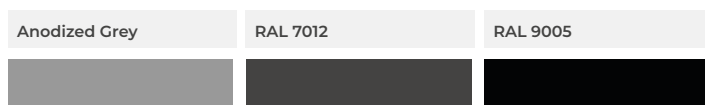

### Cable Directions

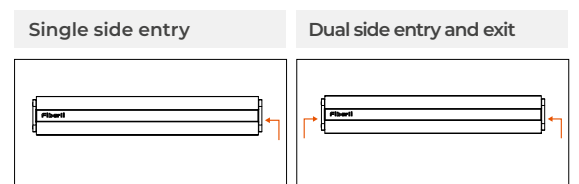



Wall Washer

# WLP



Pinpoint shot with perfect focus wall washer

WLP wallwasher, with its 4 different size options, is set to become an indispensable element in architectural and facade lighting projects. Boasting exceptional optical quality and a formidable light output, its discreet front glass detailing and sleek aluminum casing seamlessly integrate it into architectural aesthetics. Additionally, featuring horizontally adjustable legs and stainless steel connection choices, a single WLP suffices for your requirements.



Ultra Narrow  
Beam Angle



Anti Glare



High Power

## KEY FEATURES

- Ultra narrow beam angle
- Anti Glare
- High power

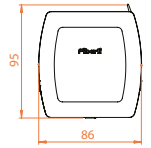
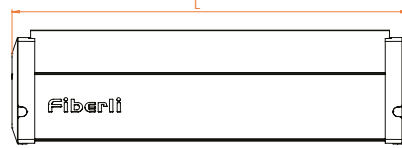

Product Overview

Light Color Options

<ul style="list-style-type: none"> <li>Warm White (3000K)</li> <li>Natural White (4000K)</li> <li>Cold White (6500K)</li> </ul>	Mono Color (MC)
<ul style="list-style-type: none"> <li>RGBW</li> </ul>	Multi Color

Power	Voltage	Luminous Flux	Length (L)
28 W	220-240V AC	3.332 lm	330 mm
56 W		6.664 lm	630 mm
84 W		9.996 lm	920 mm
112 W		13.328 lm	1220 mm
28 W	48V DC	-	330 mm
56 W		-	630 mm
84 W		-	920 mm
112 W		-	1220 mm

Lens Options

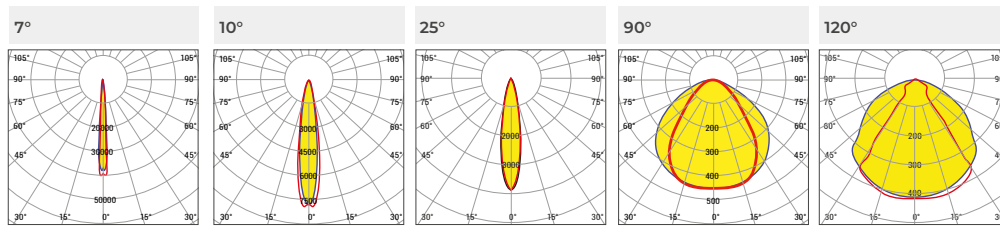

Mounting Options

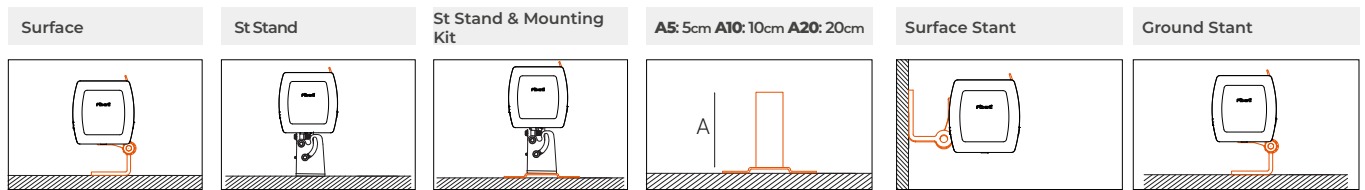

Upper Cover Options

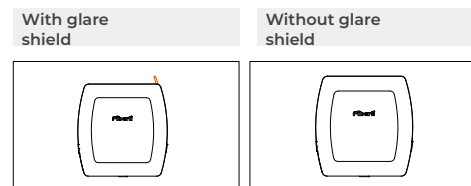

Body Color

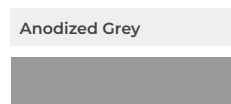

Cable Directions

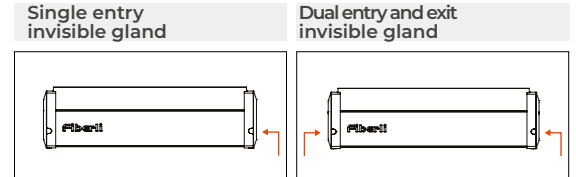

Additional Pieces Options

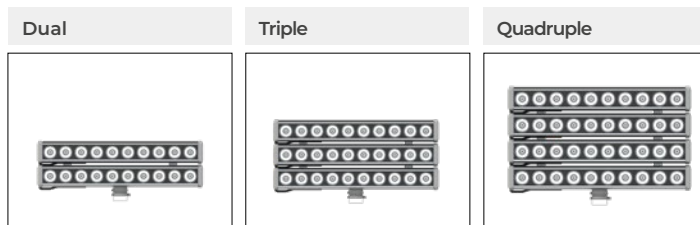



Wall Washer

# WS

## Maximum power with nanofit design wall washer

WS is a testament to innovation, where minimalism meets maximum performance. The sleek and streamlined NanoFit Design not only adds a touch of modern sophistication to any space but also houses an unparalleled cooling capacity, ensuring optimal functionality even at its peak power. In scenarios where facades present limited space for large fixtures, WS emerges as the ideal choice. Its remarkable capability to contain immense power within a minimalist housing makes it a game-changer for architects and lighting designers facing spatial constraints.



**WS1**



**WS2**



**WS3**



**WS4**



NanoFit  
Design



High  
Power



Extensive  
Optical  
Range

### KEY FEATURES

- NanoFit design is a game-changer for illuminating limited facade areas
- It provides high illumination with power options of up to 120W.
- Suitable for a diverse range of optical options in both grazing and washing applications.



Scan for more details

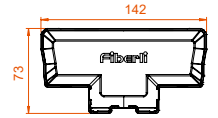
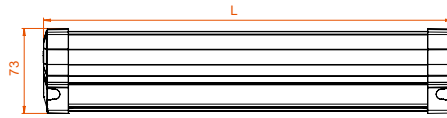

Product Overview

Light Color Options

	Red	Mono Color (MC)
	Green	
	Blue	
	Amber	
	Warm White (3000K)	
	Natural White (4000K)	
	Cold White (6500K)	
	RGB	Multi Color
	RGBW	
	RGBA	

Power	Voltage	Luminous Flux	Length(L)
18 W	220-240V AC	3.072 lm	206 mm
42 W		6.080 lm	351 mm
62 W		9.250 lm	497 mm
105 W		15.247 lm	643 mm
18 W		1.140 lm	206 mm
43 W		2.280 lm	351 mm
63 W		3.420 lm	497 mm
81 W		4.560 lm	643 mm
18 W		2.010 lm	206 mm
58 W		4.020 lm	351 mm
88 W		6.030 lm	497 mm
115 W		8.111 lm	643 mm

Lens Options

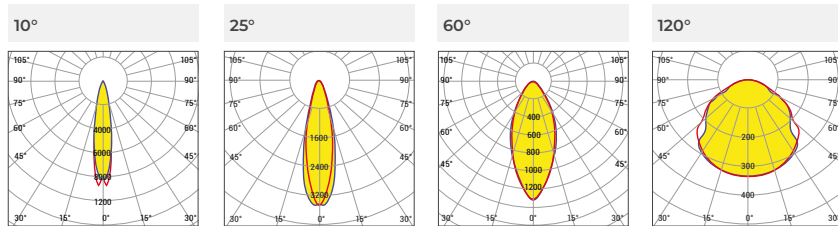

Mounting

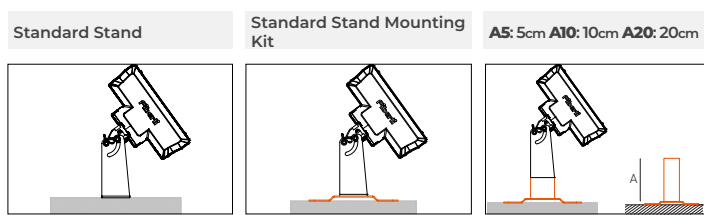

Body Color Options

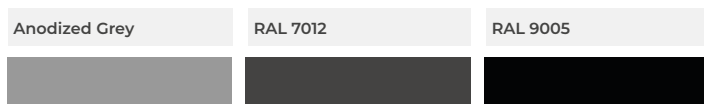

Additional Pieces Options

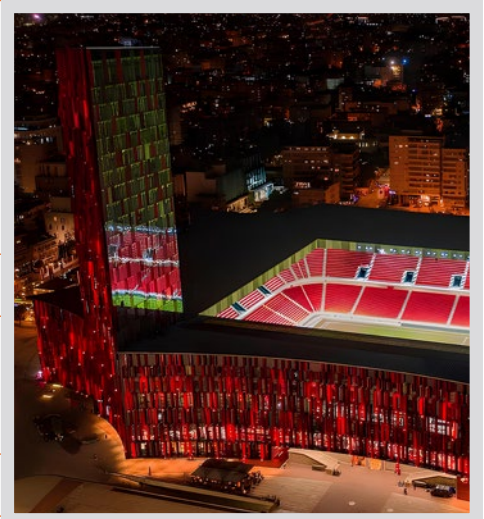
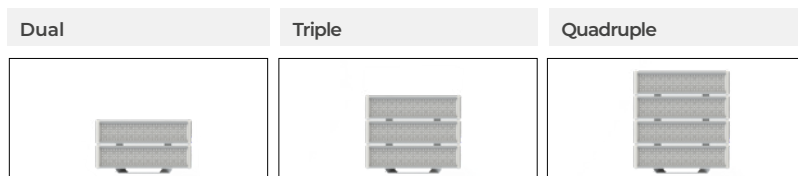



LED Projector

# SUPREME

## Power on the field

Elevate your lighting experience to an impressive 1320 watts with Supreme for field lighting. Introducing the DMX-RGBW option, which infuses viaducts and bridge illuminations with dynamic movement, transforming the entire lighting ambiance into a captivating visual spectacle. In stadiums and sports arenas, Supreme effortlessly provides a high, uniform, and balanced lighting option with its dual and triple modular combinations.



Ultra Power



DMX Full Color



Passive Cooling

### KEY FEATURES

- Ultra power
- DMX full color
- Passive cooling



Scan for more details

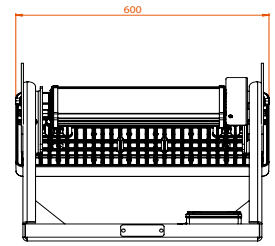
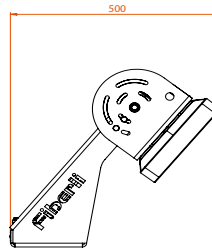
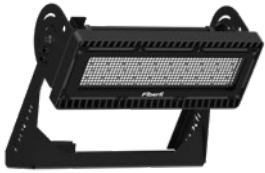

## Product Overview

### Light Color Options

<span style="color: red;">●</span> Red	Mono Color (MC)
<span style="color: green;">●</span> Green	
<span style="color: blue;">●</span> Blue	
<span style="color: orange;">●</span> Amber	
<span style="color: yellow;">●</span> Warm White (3000K)	
<span style="color: lightyellow;">●</span> Natural White (4000K)	
<span style="color: lightblue;">●</span> Cold White (6500K)	
<span style="color: red;">●</span> <span style="color: green;">●</span> <span style="color: blue;">●</span> RGBW	Multi Color

Power	Voltage	Luminous Flux	Weight
440 W	220-240V AC	58.655 lm	23 kg
880 W		114.400 lm	33 kg
1320 W		171.600 lm	43 kg
300 W		-	23,5 kg

### Lens Options

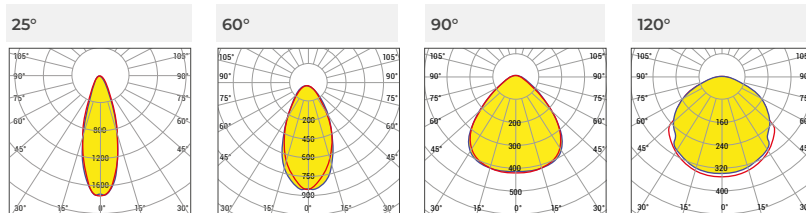

### Body Color Options

RAL 9005	RAL 9016	RAL 9007	RAL 7016

### Additional Pieces Options

Single	Dual	Triple

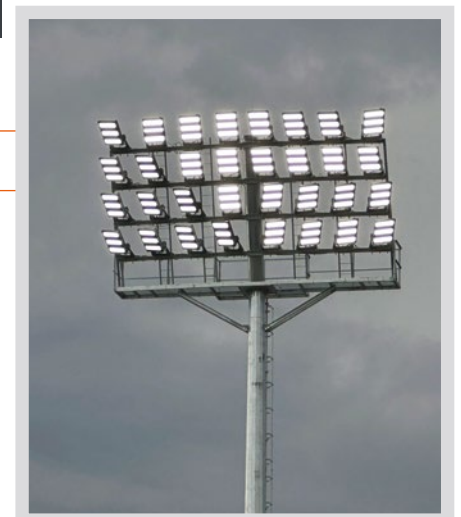





LED Projector

# SUPREME PRO

Power on the professional field

Transform your lighting experience with Supreme Pro. Experience perfect lighting in stadiums, sports arenas, and field lighting with power reaching up to 1320 watts and ultra-narrow 10-degree beam options. Supreme offers a high and homogeneous lighting option with its dual and triple modular combinations. With the DMX-RGBW option that adds dynamic movement, you can turn field lighting into a visual spectacle.



Ultra Power



DMX Full Color



Passive Cooling



Ultra Narrow Beam Angle

## KEY FEATURES

- Ultra power
- DMX full color
- Passive cooling
- Ultra narrow beam angle

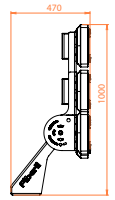
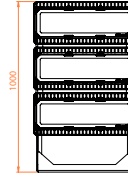
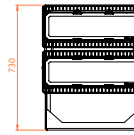
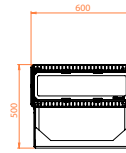
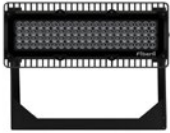

## Product Overview

### Light Color Options

<span style="color: red;">●</span> Red	Mono Color (MC)
<span style="color: green;">●</span> Green	
<span style="color: blue;">●</span> Blue	
<span style="color: orange;">●</span> Amber	
<span style="color: yellow;">●</span> Warm White (3000K)	
<span style="color: lightyellow;">●</span> Natural White (4000K)	
<span style="color: lightblue;">●</span> Cold White (6500K)	
<span style="color: cyan;">●</span> RGBW	Multi-Cooler

Power	Voltage	Weight
440 W	220-240V AC	30 kg
880 W		42 kg
1320 W		55 kg
360 W		30 kg
720 W		42 kg
1080 W		55 kg

### Lens Options

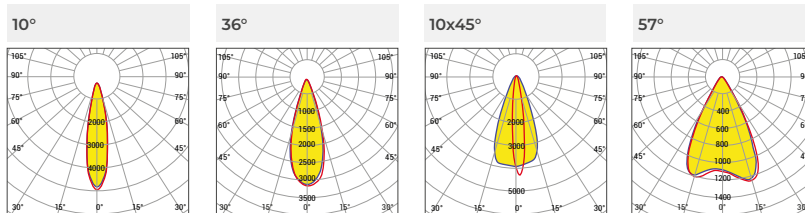

### Body Color Options

RAL 9005	RAL 9016	RAL 9007	RAL 7016

### Additional Pieces Options

Single	Dual	Triple

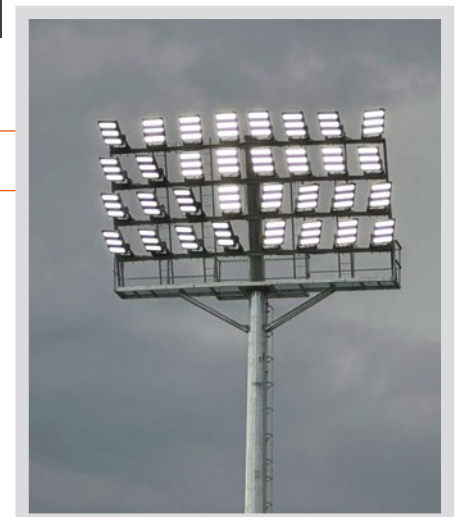



LED Projector

# WH

The WH Wallwasher H by Fiberli is a high-performance, outdoor lighting fixture designed to provide powerful and even illumination for architectural and landscape applications. Its robust construction and advanced features make it an ideal choice for highlighting building facades, bridges, monuments, and other large structures.

Enhance your architectural and landscape projects with the WH Wallwasher H, a reliable and versatile lighting solution that combines high performance, durability, and energy efficiency.



Extensive  
Optical  
Range



Durable



Passive  
Cooling

## KEY FEATURES

- Electrostatic powder coated, aluminum injection
- High cooling capacity body design
- 4mm tempered luminaire glass.
- Aluminum injection side cover
- Stainless fittings and clasp
- Electrostatic painted DKP / Galvanized mounting feet



Scan for more details

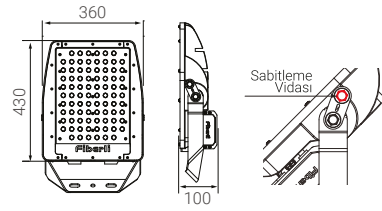

## Product Overview

### Light Color Options

	Red	Mono Color (MC)
	Green	
	Blue	
	Amber	
	Warm White (3000K)	
	Natural White (4000K)	
	Cold White (6500K)	
	RGB	Multi-Cooler
	RGBW	
	RGBA	

Power	Voltage	Luminous Flux	Weight
160 W	220-240V AC	-	10,7 kg
220 W		-	13 kg

### Lens Options

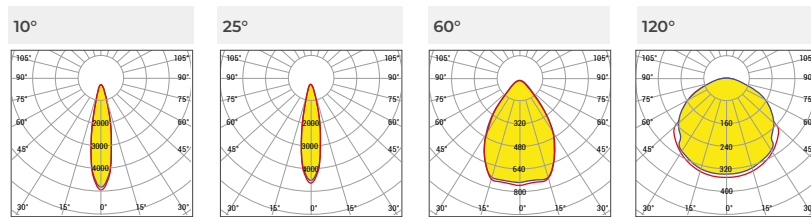

### Body Color Options

RAL 9005	RAL 9016	RAL 9007

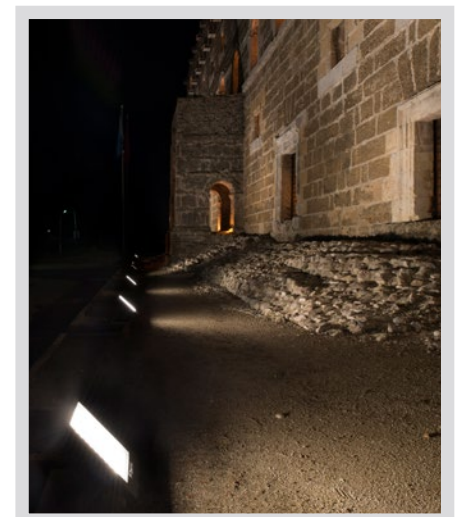



LED Projector

# WH ECO

The WH Eco Wallwasher H Eco by Fiberli is an energy-efficient and eco-friendly outdoor lighting fixture designed to provide excellent illumination for a variety of architectural and landscape applications. Its innovative design and sustainable features make it an ideal choice for those seeking powerful lighting with a minimal environmental footprint.



Extensive  
Optical  
Range



Passive  
Cooling

## KEY FEATURES

- Electrostatic powder coated aluminum injection housing
- High cooling capacity body design
- 4 mm polyurethane luminaire glass with casted gland.
- Aluminum injection side covers
- Electrostatic painted DKP / Galvanized mounting feet
- Stainless fittings and clips



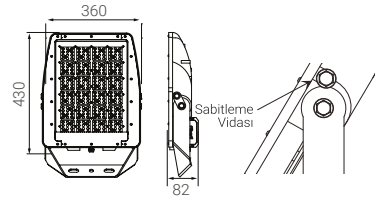

Scan for more details



Product Overview

Light Color Options

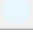
 Warm White (3000K)	Mono Color (MC)
 Natural White (4000K)	
 Cold White (6500K)	

Power	Voltage	Luminous Flux	Weight
250 W	220-240V AC	31.025	13 kg
300 W		40.635	13 kg

Lens Options

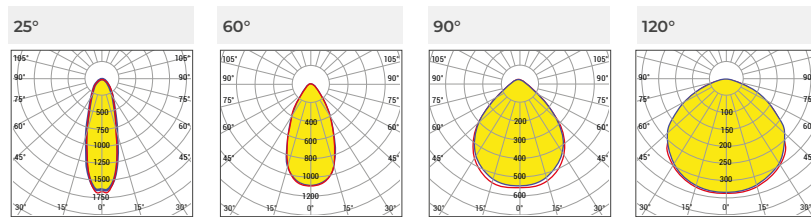

Body Color Options

RAL 9005	RAL 9016	RAL 9007
		

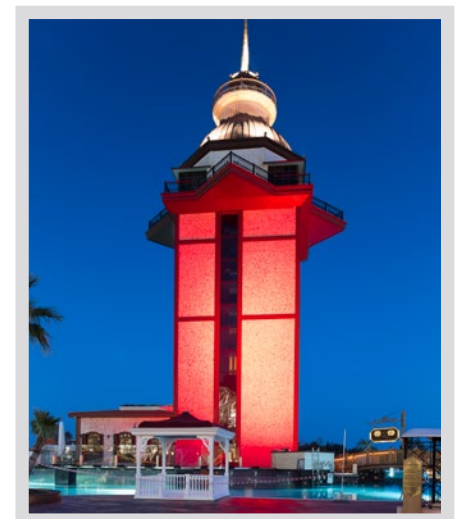



LED Projector

# WH 5D

The WH 5D LED Projectors by Fiberli offer a high-performance lighting solution designed for professional outdoor applications. With advanced LED technology and precise optics, these projectors provide powerful, focused illumination for a wide range of environments, from architectural highlights to large landscape areas.



Ultra Narrow  
Beam Angle



Durable



Passive  
Cooling

## KEY FEATURES

- Electrostatic powder coated aluminum injection housing
- 5° ultra narrow beam optics
- High cooling capacity body design
- 4 mm tempered luminaire glass
- Aluminum injection side covers
- Electrostatic painted DKP / Galvanized mounting feet
- Stainless fittings and clips



Scan for more details

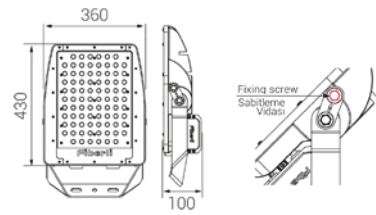

Product Overview

Light Color Options

<ul style="list-style-type: none"> <li><span style="color: orange;">●</span> Warm White (3000K)</li> <li><span style="color: yellow;">●</span> Natural White (4000K)</li> <li><span style="color: lightblue;">●</span> Cold White (6500K)</li> </ul>	Mono Color (MC)
--	-----------------

Power	Voltage	Luminous Flux	Weight
130 W	220-240V AC	11.544	13 kg
180 W		13.892	13 kg

Lens Options

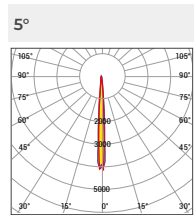

Body Color Options

RAL 9005	RAL 9016	RAL 9007







LEDLine Flex

# LLFX



## Compatible with every corner

Illuminate your spaces, save energy, and create an eye-catching ambiance with LLFX! LLFX is a flexible, durable, and energy-efficient LED lighting solution that modernizes traditional neon lighting. Designed for both indoor and outdoor use, this innovative product meets all your decorative and functional lighting needs.



Flexible

### KEY FEATURES

---

- Bendable up to 30cm in diameter
- Full resistance with IP67 protection
- Anti-UV technology
- Solid silicone extrusion
- High color rendition
- PC side cover
- High corrosion resistance

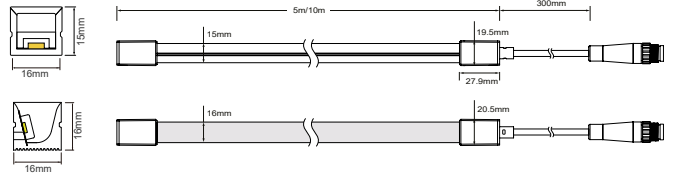

Product Overview

Light Color Options

Warm White (3000K)	Mono Color (MC)
Natural White (4000K)	
Cold White (6500K)	
RGB	Multi Color
RGBW	

Power	Voltage	LED Qty	Luminous Flux
5 W/m	220-240V AC	140	350 lm
10 W/m			672 lm
15 W/m			932 lm
5 W/m	220-240V AC	80	-
10 W/m			-
15 W/m			-

Lens Options

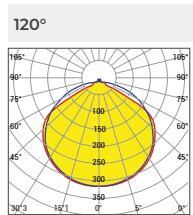

Junction Options



Viewing Side

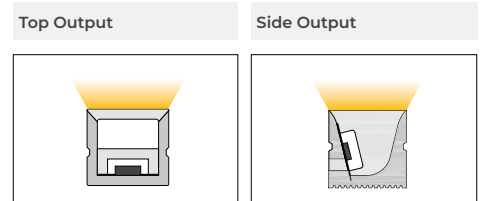

Mounting

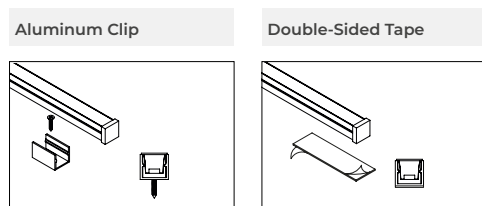

Bending Options

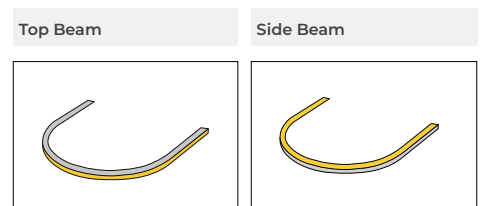

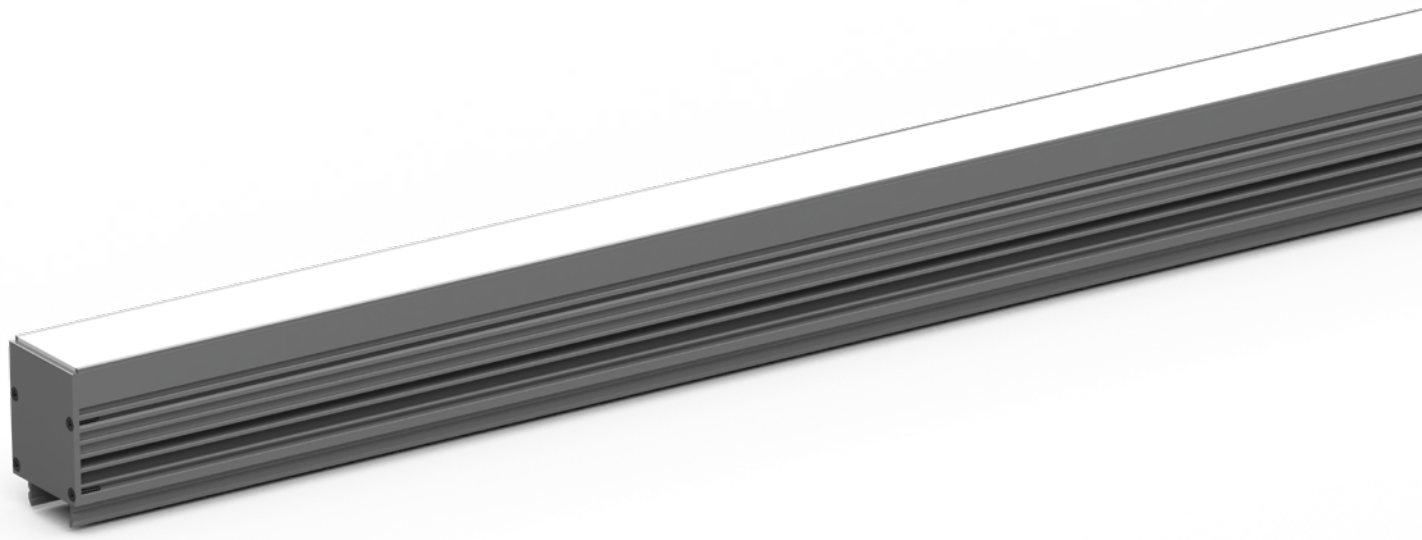

## Floor Lighting

# CFU

### Impressive at every step

The CFU recessed luminaire, available in various sizes, offers numerous design possibilities with linear lighting from ground level. Its width options open the door to creating the desired lighting design. Regardless of the surface – be it garden, concrete, rubber, or asphalt – its durable casing allows it to be embedded in almost all types of flooring, providing long-lasting resilience. The robust casing of CFU, rated at IK10 durability class, ensures it remains unaffected by the pressure effects it may face when mounted on different surfaces.

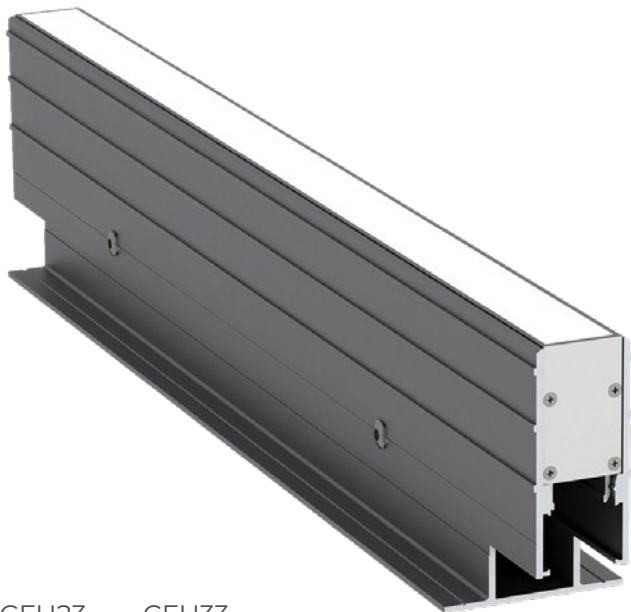

Super  
Homogeneous  
Light



Durable

### KEY FEATURES

- Super homogeneous light
- Durable body

CFU23

CFU33



Scan for more details

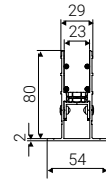
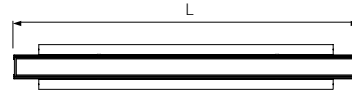

Product Overview

Light Color Options

Red	Mono Color (MC)
Green	
Blue	
Amber	
Warm White (3000K)	
Natural White (4000K)	
Cold White (6500K)	
RGB	Multi-Color
RGBW	
RGBA	

Power	Luminous Flux	Voltage	Power	Luminous Flux
18 W	450 lm	24V DC	18 W	540 lm
4,8 W	120 lm		4,8 W	150 lm
14,4 W	360 lm		14,4 W	450 lm
7,2 W	180 lm		7,2 W	220 lm
14,2 W	360 lm		14,2 W	450 lm
8,4 W	5 px/m		8,4 W	5 px/m
12,6 W	7 px/m		12,6 W	7,5 px/m
CFU23			CFU33	

Lens Options

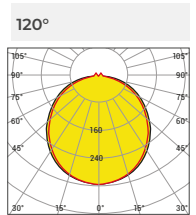

Mounting

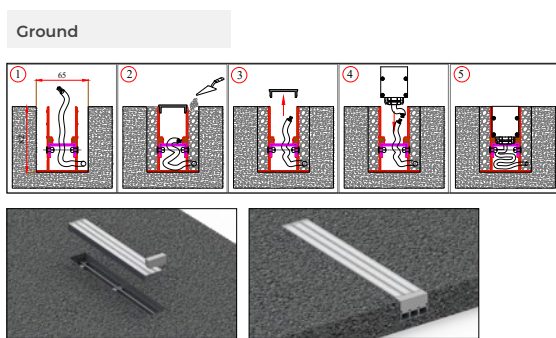

Body Color

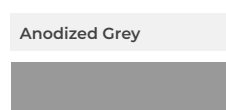

Cable Direction Options

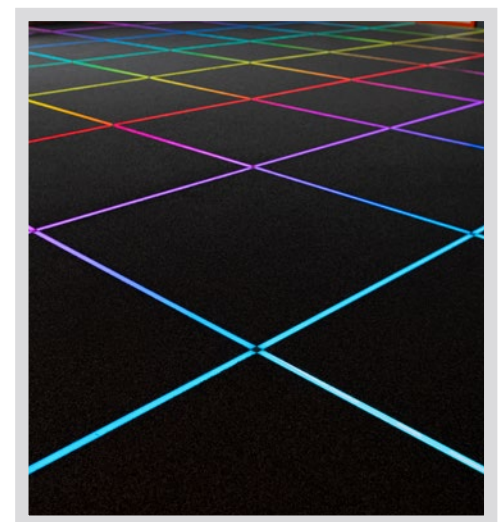
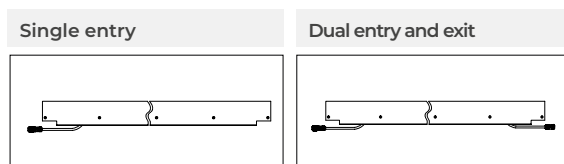



Floor Lighting

# CFL

Impressive at every step outdoor

The CFL, a linear recessed lighting fixture for flooring, offers seamless compatibility with various surfaces and lighting needs, thanks to its high-strength housing and 6mm tempered glass. With power outputs ranging from 4 to 50 watts, it has the capability to highlight architectural details from the ground up. Suitable for applications in parks, gardens, architectural settings, and facade lighting projects, the CFL is versatile and designed to meet diverse illumination requirements.



CFL03-170mm



CFL06-285mm



CFL1-380mm



CFL2-670mm



CFL3-960mm



CFL4-1250mm



Optical  
Range



316L  
Stainless  
Steel Body

## KEY FEATURES

- Optical range
- Stainless steel body



Scan for more details

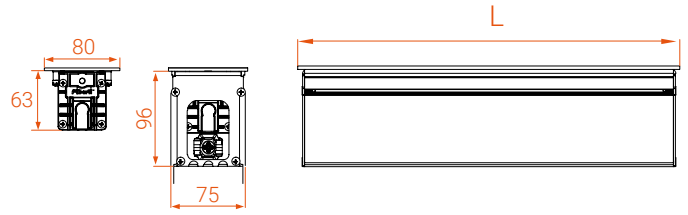
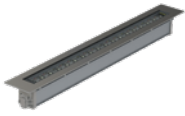

Product Overview

Light Color Options

Red	Mono Color (MC)
Green	
Blue	
Amber	
Warm White (3000K)	
Natural White (4000K)	
Cold White (6500K)	
RGB	Multi-Color
RGBW	
RGBA	

Power	Voltage	Luminous Flux	Length(L)
4 W	220-240V AC	500 lm	170 mm
8 W		1.000 lm	285 mm
10 W		1.300 lm	380 mm
20 W		2.605 lm	670 mm
30 W		3.700 lm	960 mm
40 W		5.030 lm	1250 mm
12 W	12V DC	-	380 mm
25 W	24V DC	-	670 mm
40 W	12V DC	-	960 mm
50 W	24V DC	-	1250 mm

Lens Options

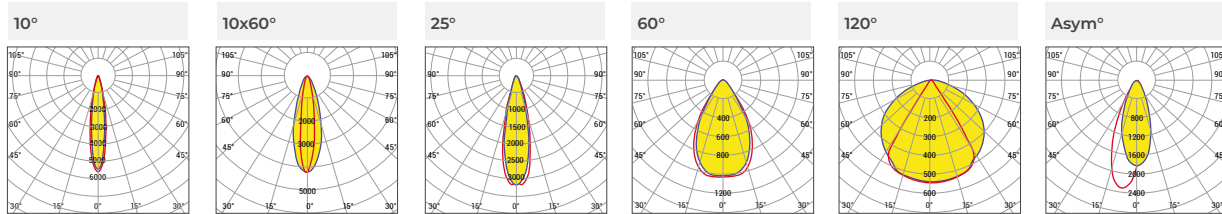

Body Color

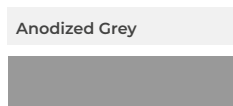

Cable Direction Options

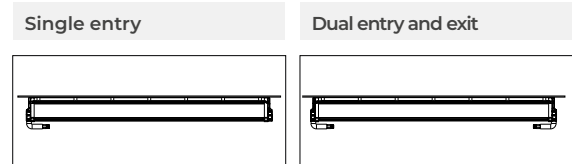

Mounting

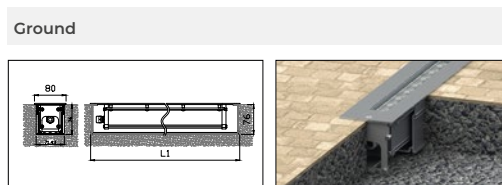



Floor Lighting

# CF1

## Floor decoration with lighting

Featuring a range of enclosure sizes, CF1, CF3, and CF5 enable precise illumination targeting for specific objects or areas. Specifically crafted for recessed installation across various flooring options, these fixtures are shielded from external impacts by their robust front glass. Whether in parks, gardens, walkways, indoor spaces, or to highlight diverse objects, you have the flexibility to choose a CF with varying power options.



Lightweight  
Body



Stainless  
Steel Body

### KEY FEATURES

- 316 L chrome body and chrome spot frame
- Electrostatic powder coated aluminum injection body
- 8 mm tempered glass
- Plastic injection installation box
- Underwater cable joint
- H07RNF rubber cable



Scan for more details

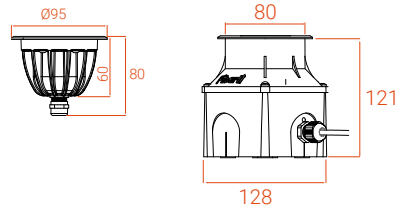

Product Overview

Light Color Options

<span style="color: red;">●</span> Red	Mono Color (MC)
<span style="color: green;">●</span> Green	
<span style="color: blue;">●</span> Blue	
<span style="color: orange;">●</span> Amber	
<span style="color: yellow;">●</span> Warm White (3000K)	
<span style="color: lightyellow;">●</span> Natural White (4000K)	
<span style="color: lightblue;">●</span> Cold White (6500K)	
<span style="color: red;">●</span> <span style="color: green;">●</span> <span style="color: blue;">●</span> RGB	Multi-Color

Power	Voltage	Luminous Flux	Weight(kg)
4 W	220-240V AC	480 lm	1,3
4 W	12-24V DC	425 lm	1,1
8 W	7,5V DC	-	1,1

Lens Options

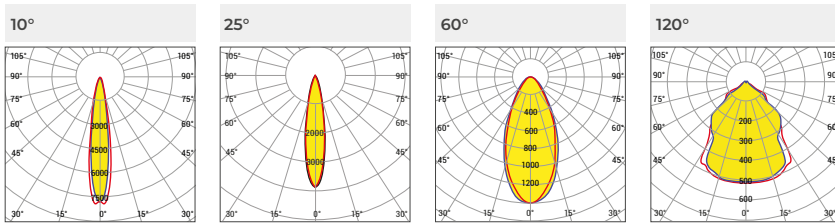

Mounting

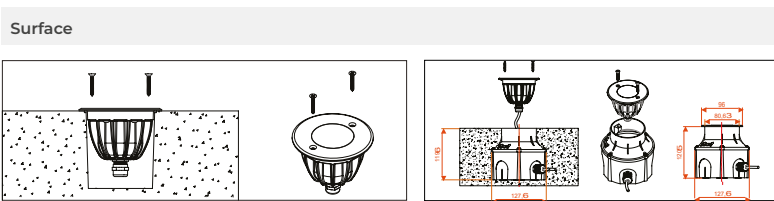

Upper Piece Options





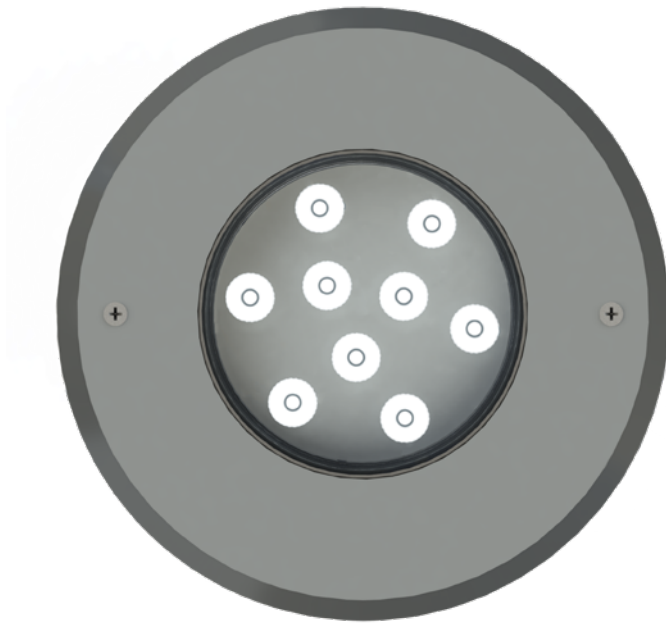

Floor Lighting

# CF3

## Floor decoration with lighting

Featuring a range of enclosure sizes, CF1, CF3, and CF5 enable precise illumination targeting for specific objects or areas. Specifically crafted for recessed installation across various flooring options, these fixtures are shielded from external impacts by their robust front glass. Whether in parks, gardens, walkways, indoor spaces, or to highlight diverse objects, you have the flexibility to choose a CF with varying power options.



Lightweight  
Body



Stainless  
Steel Body

### KEY FEATURES

- 5 mm 316 L chrome flange
- Electrostatic powder coated aluminum injection body
- 12 mm tempered glass
- Plastic injection installation box
- Underwater cable joint
- H07RNF rubber cable
- IP68 air vent



Scan for more details

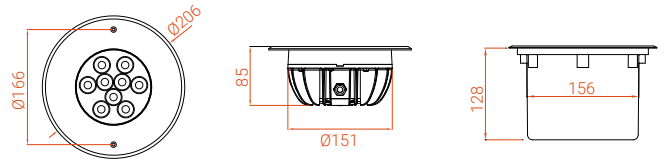

Product Overview

Light Color Options

	Red	Mono Color (MC)
	Green	
	Blue	
	Amber	
	Warm White (3000K)	
	Natural White (4000K)	
	Cold White (6500K)	
	RGB	Multi-Color

Power	Voltage	Luminous Flux	Weight(kg)
10 W	220-240V DC	1.000 lm	2,8
8 W	220-240V DC	-	2,8
13 W	12V DC	-	2,6

Lens Options

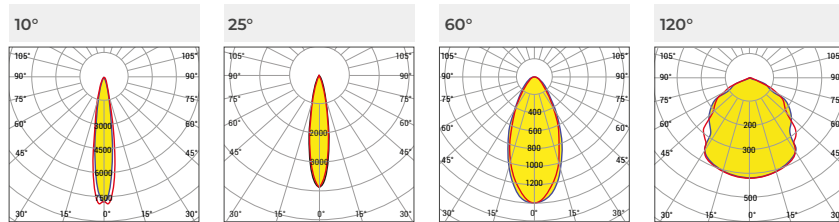

Mounting



Cable Direction Options

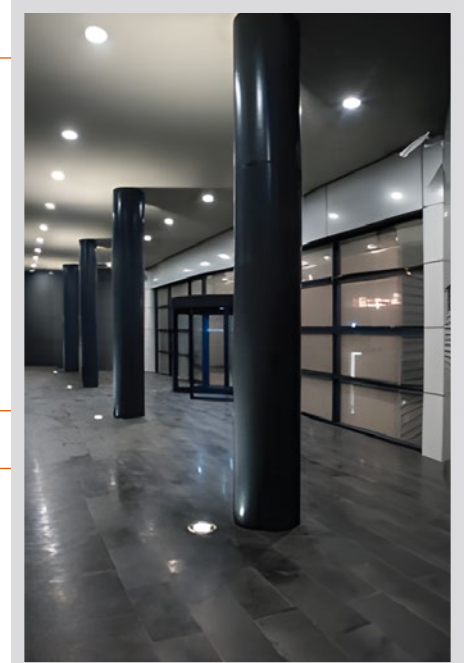



Floor Lighting

# CF5

## Floor decoration with lighting

Featuring a range of enclosure sizes, CF1, CF3, and CF5 enable precise illumination targeting for specific objects or areas. Specifically crafted for recessed installation across various flooring options, these fixtures are shielded from external impacts by their robust front glass. Whether in parks, gardens, walkways, indoor spaces, or to highlight diverse objects, you have the flexibility to choose a CF with varying power options.



Lightweight  
body



Stainless  
Steel Body

### KEY FEATURES

- 5 mm 316 L chrome spot frame
- Electrostatic powder coated aluminum injection body
- 12 mm tempered glass
- Plastic injection installation box
- Underwater cable joint
- H07RNF rubber cable
- Pressure compensating valve



Scan for more details

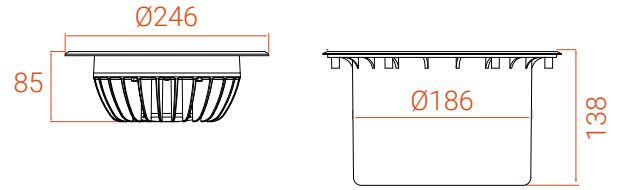

Product Overview

Light Color Options

	Red	Mono Color (MC)
	Green	
	Blue	
	Amber	
	Warm White (3000K)	
	Natural White (4000K)	
	Cold White (6500K)	
	RGB	Multi-Color
	RGBW	
	RGBA	

Power	Voltage	Luminous Flux	Weight(kg)
21 W	220-240V DC	2.625 lm	3,8
25 W	24V DC	-	3,5
26 W		-	3,5

Lens Options

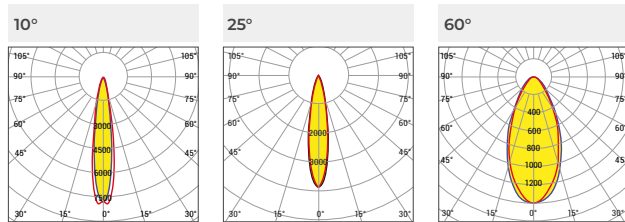

Mounting

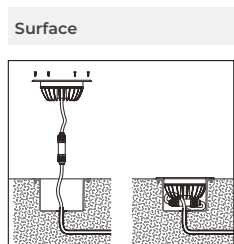

Cable Direction Options

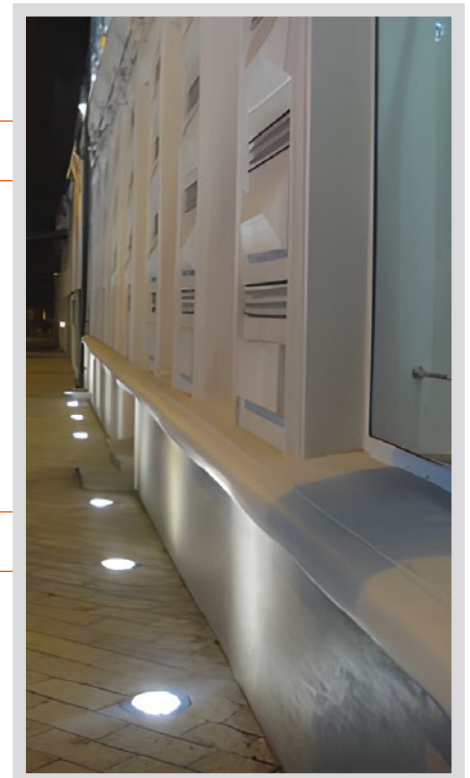



Architectural Lighting

# SNAKE



Rotatable architecture luminaire

Snake is a linear lighting luminaire with high output brightness, compact design, and flexible solutions, offering an IP66 rating for durability in various environments. Its modular design and the ability to be seamlessly joined allow for direct grazing on any surface that needs illumination. With enhanced optical designs, Snake provides high lighting capability even when positioned in tight spaces.



Rotatable



DMX Full  
Color

## KEY FEATURES

---

- Rotatable body
- DMX full color

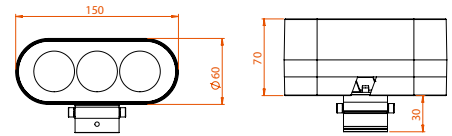

## Product Overview

### Light Color



RGBW

### Power Voltage

6 W

48V DC

## Lens Options

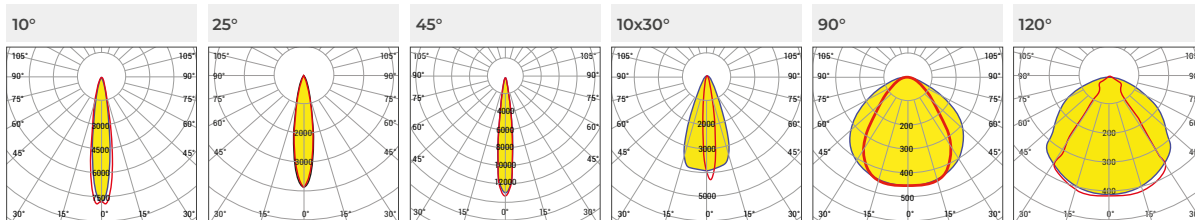

## Body Color Options

RAL 9016

RAL 9005



## Mounting

Wall

Surface

Surface Mount

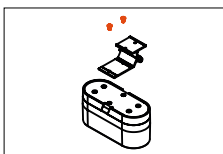
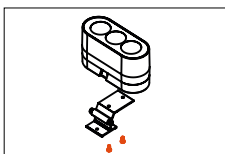
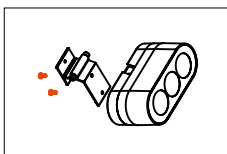



## Architectural Lighting

# IZ

### Trace on the wall

Introducing our cutting-edge linear lighting solution, featuring an electrostatic powder-coated aluminum injection housing for unmatched durability. Equipped with an ultra-elliptical  $3.8^\circ \times 116^\circ$  lens, this product delivers precise lighting with an integrated mechanism adjustable up to 7.0 degrees. Designed specifically for inclined windows, it provides a seamless, linear lighting effect, enhanced by an internal drive for optimal performance. Illuminate your spaces with precision and style using our advanced lighting technology.

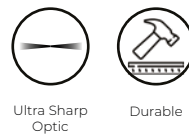



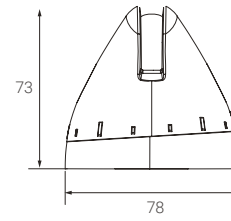

#### KEY FEATURES

- Electrostatic powder coated aluminum injection housing
- Ultra elliptical  $3,8^\circ \times 116^\circ$  lens
- Integrated mechanism adjustable up to 7.0 degrees
- Internal drive
- Used on specially designed inclined windows
- Linear lighting effect





Product Overview

Light Color Options

 Amber	Mono Color (MC)
 Warm White (3000K)	
 Natural White (4000K)	
 Cold White (6500K)	

Power	Voltage	Luminous Flux	Weight
5 W	220-240V AC	400	0,5 kg

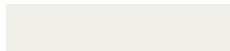
Body Color Options

RAL 9005	RAL 9016	RAL 9007
		





Architectural Lighting

# CIZ



## Trace on the wall

Complete your lighting design with the Ciz LED luminaire, which naturally emphasizes pathways and architectural details in both indoor and outdoor settings. With various housing options, Ciz ensures seamless integration with different design concepts. Offering indirect and glare-free illumination, Ciz allows you to achieve natural lighting effects.

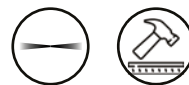

Ultra Sharp  
Optic

Durable

### KEY FEATURES

---

- Ultra sharp optic
- Durable body

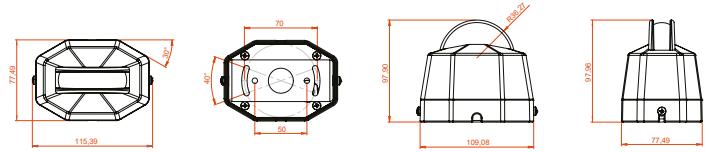

Product Overview

Light Color Options

<span style="color: red;">●</span> Red	Mono Color (MC)
<span style="color: green;">●</span> Green	
<span style="color: blue;">●</span> Blue	
<span style="color: orange;">●</span> Warm White (3000K)	
<span style="color: yellow;">●</span> Natural White (4000K)	
<span style="color: lightblue;">●</span> Cold White (6500K)	

Power	Voltage
6 W	220-240V AC

Lens Options

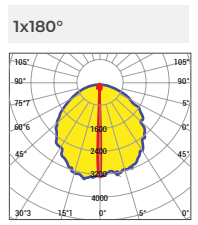

Mounting

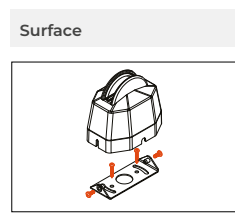

Body Color Options





Architectural Lighting

# BELLA



Meet Bella, the complement to your architectural outdoor designs. With various mounting options, you can accentuate objects in landscapes or create a pleasant and simple garden lighting with the direct overhead mounting option. With its IP67 protection and durable casing, Bella certifies its strength in outdoor settings.

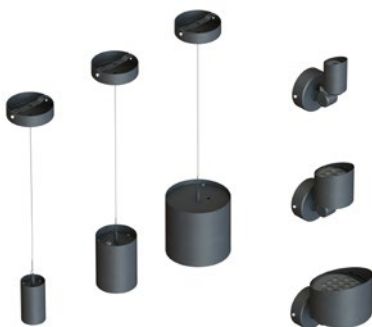

Moduler Body



Elegant Design



DMX Full Color

## KEY FEATURES

- Moduler body
- Elegant design
- DMX full color



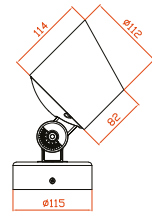

Product Overview

Light Color Options

- Red
- Green
- Blue
- Warm White (3000K)
- Natural White (4000K)
- Cold White (6500K)

Mono Color (MC)

- ● ● RGB
- ● ● ● RGBW

Multi Color

Power	Voltage	Luminous Flux
20 W	220-240V AC	1.700 lm
20 W	48V DC	-

Lens Options

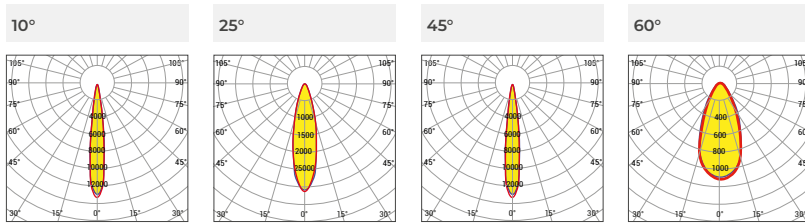

Mounting

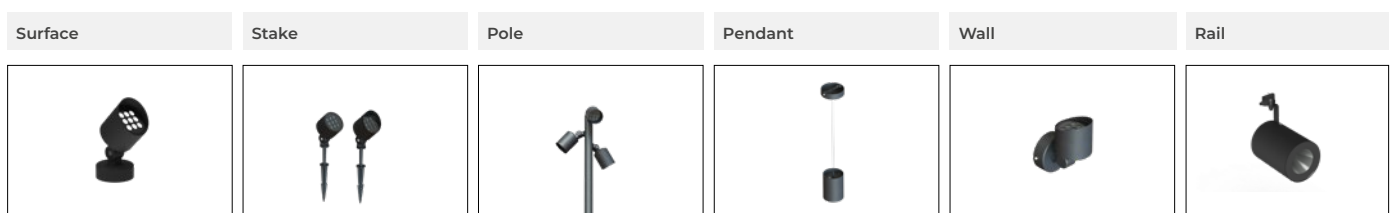

Upper Cover Options

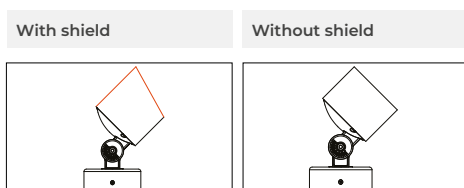

Body Color Options

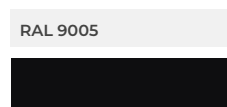

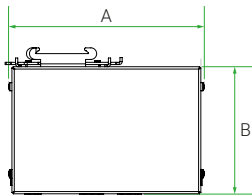
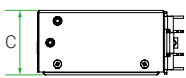

Fiberli Node2X is a DMX512-Ethernet interface device. Converts Art-Net™ packets over the network into suitable DMX512 data. Its power comes from the ARM architecture, high-speed processor. Provides stable and reliable operation. Via the web configuration interface, settings such as IP address, port numbers can be easily changed and the current status can be displayed. Compatible with all control software that supports the commonly used Art-Net™ protocol.

- Art-Net™ input signal
- 2-PORT DMX512 output signal
- XLR ve Socket options
- High speed ARM processor
- Web configuration interface
- Perfect compatibility with all protocol compliant software
- Rail, Wall ve Rack mounting options
- 100Mbit/s Ethernet speed
- Quick start
- Short circuit and ESD protection on output ports
- Data/Link status information lights
- Universal input voltage range (85~265VAC)
- Short-term plug and unplug of Ethernet cables while it is in operation (Hot plug)
- Plug and play operation without initial reconfiguration

## Technical Specifications

Specification	Parameter	Explanation			
		33600816	33600817	33600818	33600819
Electrical	Input Voltage	24VDC			
	Power Input Socket	2-Pin Plug-in Socket			
	Power consumption	2.4W			
Functional	Data Input Signal	Art-Net™			
	Data Input Socket	RJ45			
	Ethernet Speed	10/100 MBit/s			
	Ethernet Features	Auto-Neg. , Auto-MDIX			
	Data Output Signal	DMX512			
	Data Output Socket	XLR-3PIN	Socket	Socket	Socket
	Data Output Ports	2			
	Total DMX Channels	1024			
Physical	Dimensions (AxBxC)	135x104x44,5	135x87,8x44,5	170x87,8x44,5	466x87,8x44,5
	Operating temperature	-10°C ~ 60°C			
	IP Class	IP20			

## Product Options

Stock code	Stock name	Connection Type	Mounting Type
33600816	LED CONTROLLER NODE2X XLR 3-Pin Din-Rail 24VDC	XLR 3-PIN	Rail
33600817	LED CONTROLLER NODE2X Socket Din-Rail 24VDC	Socket 3-PIN	Rail
33600818	LED CONTROLLER NODE2X Socket Wall-Mount 24VDC	Socket 3-PIN	Wall
33600819	LED CONTROLLER NODE2X Socket Rack-Mount 24VDC	Socket 3-PIN	1U Rack



Fiberli Node8X is a DMX512-Ethernet interface device. Converts Art-Net™ packets over the network into suitable DMX512 data. Its power comes from the ARM architecture, high-speed processor. Provides stable and reliable operation. Via the web configuration interface, settings such as IP address, port numbers can be easily changed and the current status can be displayed. Compatible with all control software that supports the commonly used Art-Net™ protocol.

- Art-Net™ input signal
- 8-PORT DMX512 output signal
- High speed ARM processor
- Web configuration interface
- Perfect compatibility with all protocol compliant software
- Durable 1U Rack Case
- 100Mbit/s Ethernet speed
- Quick start
- Short circuit and ESD protection on output ports
- Data/Link status information lights
- Universal input voltage range (85~265VAC)
- Short-term plug and unplug of Ethernet cables while it is in operation (Hot plug)
- Plug and play operation without initial reconfiguration

## Technical Specifications

Specification	Parameter	Explanation
Electrical	Input Voltage	85~265 V AC
	Input Voltage Frequency	47~63Hz
	Power Input Socket	Standard 3-pin 250V 10A IEC C14 Socket
	Power consumption	2.4W
Functional	Data Input Signal	Art-Net™
	Data Input Socket	RJ45
	Ethernet Speed	10/100 MBit/s
	Ethernet Features	Auto-Neg. , Auto-MDIX
	Data Output Signal	DMX512
	Data Output Socket	3-Pin Female XLR Socket
	Data Output Ports	8
	Total DMX Channels	4096
Physical	Rack Size	19" X 1U
	Dimensions	479.4mmx110.8mmx45mm
	Operating temperature	-10°C ~ 60°C
	IP Class	IP20

Stock code: 33600759

## Technical drawing

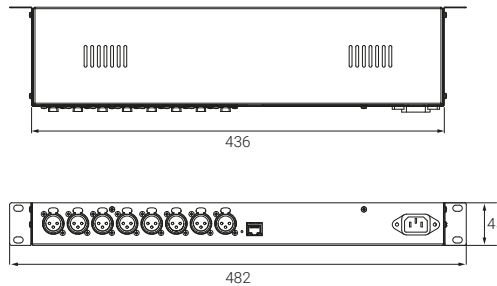

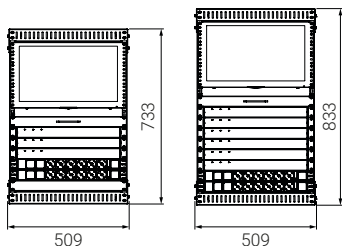

Ready PC-Start-Mini-Midi

Maxi

FIBERLI IndustrialPRO ALL-IN-ONE Set, is an integrated light control station designed and customized for Art-Net/DMX based lighting. It runs the software that enables the animation data to be sent via Art-Net packages over the Ethernet line. Thanks to the 8-Port 1000Mbit/s internal Ethernet switch, it reduces the required Ethernet sharing load. Although it has low power consumption, it works very quietly. With USB 3.0-WiFi Connection, it allows remote access without damaging the existing lighting data line. With the surge protected group sockets, it ensures that all devices within its body are supplied from a single point.

- High speed Intel i5 Processor
- 16GB DDR4 Ram, 120Gb SSD Memory
- Windows 10 PRO 64Bit License
- 8-PORT 1Gbit / s Internal Ethernet Switch
- 19" widescreen monitor
- Ultra-quiet operation
- Low power consumption
- Durable Rack Case
- Plug-and-Play Ease of Use
- Fast boot and start

## Technical Specifications

Specification	Parameter	Ready	Start	Mini	Midi	Maxi
Electrical	Input Voltage	85~265 V AC				
	Frequency	47~63Hz				
	Number of Power Socket(*)	3/6	4/6	5/6	7/12	9/12
	Surge Protection	VAR				
	Max Power Consumption	55W	60W	65W	70W	75W
Functional	Processor 19" x 14U	Intel i5-7300U 2.6GHz				
	RAM	16GB DDR4				
	Memory	120GB SSD				
	WiFi	YES (External USB Dongle)				
	Ethernet	1Gbit/s				
	Display Unit	19" HD LCD Monitor				
Physical	Body	19" x 14U	19" x 14U	19" x 14U	19" x 14U	19" x 14U
	Total Weight					
	Operating Temperature	0°C ~ 40°C				
	IP Class	IP20				

(\*) Used/Total

## Product Information

Ready PC	Start Set	Mini Set	Midi Set	Maxi Set
Internal Industrial PC (Fiberli IndustrialPRO) 8-Port Gigabit Ethernet Support (Fiberli Gigabit Ethernet Switch)				
14U Black Metal Rack Enclosure	8 - Universe DMX Output	16 - Universe DMX Output	32 - Universe DMX Output	48 - Universe DMX Output
Group Socket 6 Outlets	(1x Fiberli Node8X)	(2x Fiberli Node8X)	(4x Fiberli Node8X)	(6x Fiberli Node8X)
	14U Black Metal Rack Enclosure	14U Black Metal Rack Enclosure	14U Black Metal Rack Enclosure	16U Black Metal Rack Enclosure
	Group Socket 6 Outlets	Group Socket 6 Outlets	Group Socket 12 Outlets	Group Socket 12 Outlets
Wireless Keyboard Mouse Set and Drawer External WiFi Dongle Mounting Accessories (Screw, Nut, Dowel etc.)				

## Connection

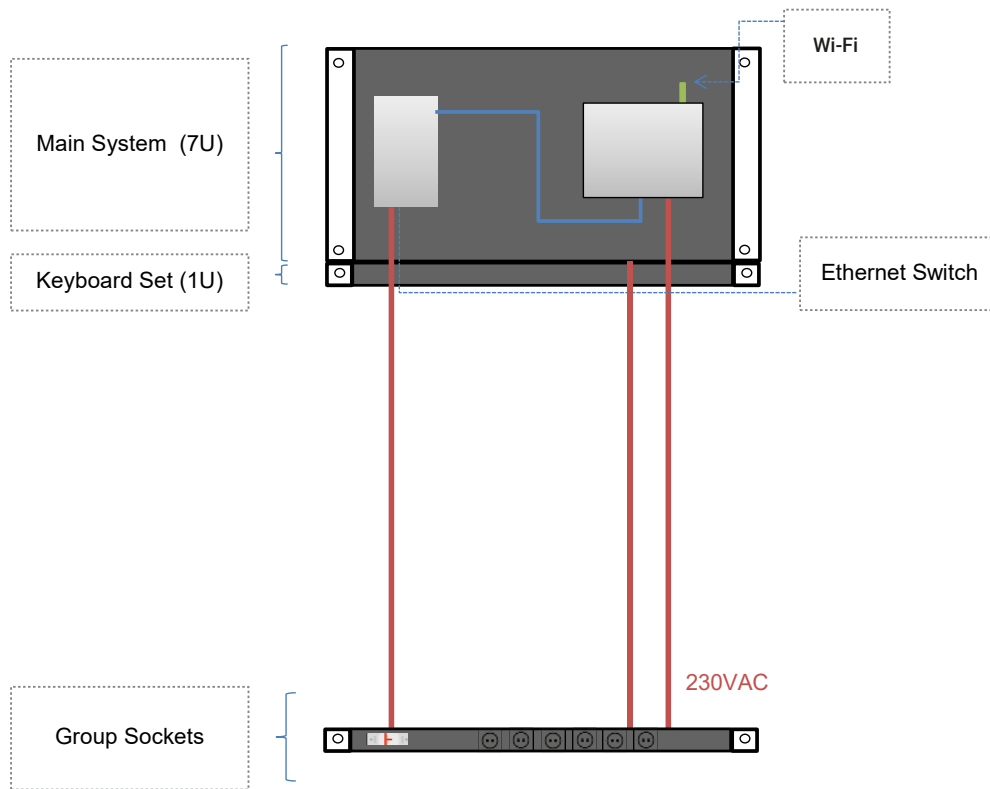



# Fiberli Features



**Balanced High Voltage:** Feature eliminates the need for electrical feedback cables in the field.



**True Color:** Ensuring a vibrant and consistent look across the entire project by managing energy for each color



**Lock & Light:** Operate effortlessly by plugging into sockets, thanks to feedback-free technology



**Slim Design:** As thin as a pencil sharpener on your desk, and additionally, produced with 30% less material.



**Active Shield:** It prevents unwanted glares with its special shield design.



**Anti Glare:** It provides homogeneous and balanced illumination by preventing unwanted glares.



**High Graze:** High-graze effect that highlights textures up to 12 meters.



**Dual Output:** Dual-directional lighting experience in a single fixture.



**Precise Beam:** Precise light angles are obtained through the right lens and manufacturing technology.



**Ultra Lightweight:** It does not impact the statics of the applied area, thanks to its ultra-light design.



**Easy Setup System:** Quick application thanks to easy installation.



**NanoFit Design:** With its stylish and minimalistic design, it seamlessly blends into the applied areas.



**High Power:** Highly efficient output power of up to 120 watts.



**Extensive Optical Range:** Optical range options that cater to both specific and general lighting needs.



**Endless Connections:** Unlimited connection side by side with an easy connection adapter



**Ultra Narrow Beam Angle:** Narrow angle options tailored for different architectural designs



**Durable:** Fully resistant to adverse external factors



**DMX Full Color:** Unique true colors thanks to the 4-in-1 chip technology



**Passive Cooling:** Special design casing cooling maximizing air exchange



**Super Homogeneous Light:** Uniform tone lighting from end to end in architectural projects



**Stainless Steel Body:** Steel body providing long-term durability



**Rotatable:** Illumination option to desired points thanks to the movable casing



**Modular Body:** Full compatibility with projects with special attachments for different usage areas



**Elegant Design:** Design complemented with decorative and architectural lines



**Ultra Sharp Optic:** Sharp angles with high optical technology



**Ultra Power:** Efficient light output at high power levels



**Flexible:** Versatile power management durable, bendable design for flexible installation



*A better way to seee!*

*"From Lykia with love, the country of lights"*

PSL ELEKTRONİK SAN. ve TİC. A.Ş.

Headquarter - Factory: Organize Sanayi Bölgesi 3. Etap 25. Cad. No: 30  
Döşemealtı / ANTALYA  
Tel: +90(242) 228 81 50 (Pbx) Fax: +90(242) 228 16 18

[www.fiberli.com](http://www.fiberli.com)

